



嘉兴伯恩利精密机械有限公司
JIAXING BURNLEY PRECISION MACHINERY CO. LTD

企业简介

嘉兴伯恩利精密机械有限公司是一家专业生产销售滚针轴承及无油滑动轴承的企业，产品畅销海内外。

我们的理念：质量，服务，价格！

质量：更好更稳定的产品质量！

服务：最大限度满足客户的需求！

价格：市场化的合理价格！

主要产品：冲压外圈滚针轴承、实体套圈滚针轴承、推力平面滚针轴承、无油润滑轴承、边界润滑轴承、JF 双金属轴承、青铜卷制轴承、固体润滑轴承、青铜铸造轴套。

广泛使用在机械制造、汽车行业、工程机械、建筑机械、农业机械、林业机械、纺织机械、冶金行业、水利水电、轧钢设备、石油和采矿机械、办公自动化产品、健身器材、食品机械、印刷等多个领域。

Jiaxing Burnley Precision Machinery Co., Ltd. a professional manufactory and sales Needle roller bearing and oilless bearings. Now our products are exported to more than 15 countries and regions in EU, America, Asia, etc.

Quality: Better and stable quality!

Service: Meet the customer's requirement as possible as we can!

Price: Reasonable prices as the market

Main product: Drawn cup needle roller bearing, solid bushed needle roller bearing, Thrust bearing, oilless bearings, Boundary lubrication bearings, JF bimetal bearings, Bronze wrapped bearings, Solid lubricating bearings bronze Turned bearings etc.

The products are applied to metallurgy extensively, automobile, mine, petroleum, such various kinds of machinery as rolling mill, chemical industry, electrical machinery, shipping, printing, plastic machinery, office equipment, health and fitness facilities, light industry and machinery, irrigation works, hydraulic pressure machinery, locomotive, rotate, slip, etc.

检测设备 Detection Device



测长仪
Length measuring instrument



硬度仪
Hardness tester



轮廓仪
Contour instrument



圆柱度仪
Cylindrical instrument

目录 CONTENTS

1. 滚轮轴承 Roller Bearing

轴承代号 Designation	
KR KR..-PP KPE..-PP KPE..-PP	01~04
CF...BR CF...VBR KRE KRVE...PP	05~06
NUTR NUTR...X	07
PWTR..-2RS PWTR..-2RS...X	08
NAST NAST...R	09
NAST...ZZ NAST...ZZR NAST...ZZUU NAST...ZZUUR	10

2. 实体套圈滚针轴承 Machined Type Needle Roller Bearings

轴承代号 Designation	
NK NKS RNA49 RNA69	11~20
NKI NKIS RA49 RA69	11~20

3. 平面推力滚针轴承和垫圈 Axial Needle Roller Thust Bearings and Washers

轴承代号 Designation	
AXK	21
AS GS811 WS811 LS	22

4. 冲压外圈滚针轴承 Drawn Cup Needle Roller Bearing

轴承代号 Designation	
HK BK	23~24

5. 冲压外圈滚针离合器 Drawn Cup Roller Clutch

轴承代号 Designation	
HF RC..FS HFL RCB..FS	25

6. 向心滚针和保持架组件 Radial Needle Roller and Cage Assemblies

轴承代号 Designation	
K K..-ZW	26~27

螺栓滚轮轴承 Stud Type Track Rollers

轴向引导
With axial guidance

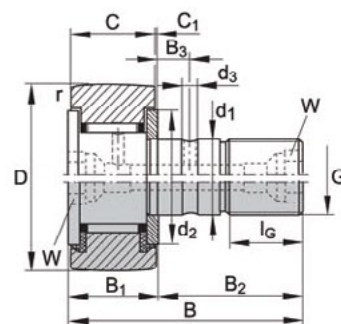
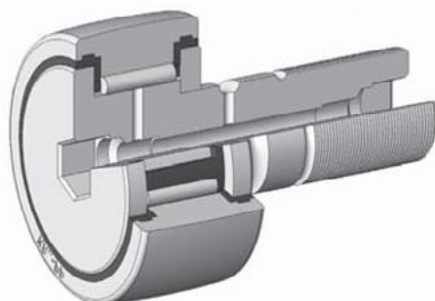

from D = 22 mm $\frac{KR}{KR..PP}$ (R = 500 mm)

外径 Outside Diameter mm	轴承型号 Bearing Designation	质量 (克) Mass ≈ g	带偏心套型号 With eccentric collar Designation	质量 (克) Mass ≈ g	尺寸(毫米) Dimensions(mm)									
					D	d ₁ h7	B	B ₁ max.	B ₂	B ₃	C	C ₁	r min.	d ₂
16	KR16 ¹⁾	19	-	-	16	6	28	12.2	16	-	11	0.6	0.15	12.5
16	KR16-PP ¹⁾	18	KRE16-PP ¹⁾	20	16	6	28	12.2	16	-	11	0.6	0.15	12.5
16	KR16-SK-PP ²⁾	19	-	-	16	6	28	12.2	16	-	11	0.6	0.15	12.5
16	KRV16-PP ¹⁾	19	-	-	16	6	28	12.2	16	-	11	0.6	0.15	12.5
19	KR19 ¹⁾	29	-	-	19	8	32	12.2	20	-	11	0.6	0.15	15
19	KR19-PP ¹⁾	29	KRE19-PP ¹⁾	32	19	8	32	12.2	20	-	11	0.6	0.15	15
19	KR19-SK-PP ²⁾	29	-	-	19	8	32	12.2	20	-	11	0.6	0.15	15
19	KRV19-PP ¹⁾	31	-	-	19	8	32	12.2	20	-	11	0.6	0.15	15
22	KR22	45	-	-	22	10	36	13.2	23	-	12	0.6	0.3	17.5
22	KR22-PP	43	KRE22-PP	47	22	10	36	13.2	23	-	12	0.6	0.3	17.5
22	KRV22-PP	45	-	-	22	10	36	13.2	23	-	12	0.6	0.3	17.5
26	KR26	59	-	-	26	10	36	13.2	23	-	12	0.6	0.3	17.5
26	KR26-PP	57	KRE26-PP	62	26	10	36	13.2	23	-	12	0.6	0.3	17.5
26	KRV26-PP	59	-	-	26	10	36	13.2	23	-	12	0.6	0.3	17.5
30	KR30	92	-	-	30	12	40	15.2	25	6	14	0.6	0.6	23
30	KR30-PP	88	KRE30-PP	93	30	12	40	15.2	25	6	14	0.6	0.6	23
30	KRV30-PP	91	-	-	30	12	40	15.2	25	6	14	0.6	0.6	23
32	KR32	103	-	-	32	12	40	15.2	25	6	14	0.6	0.6	23
32	KR32-PP	98	KRE32-PP	104	32	12	40	15.2	25	6	14	0.6	0.6	23
32	KRV32-PP	101	-	-	32	12	40	15.2	25	6	14	0.6	0.6	23

¹⁾ Relubrication hole only on the flange-side end face with slot for countertensioning during fitting.
法兰端为一字槽带润滑油孔，可再润滑。

²⁾ Hexagonal socket only on the flange-side end face. No relubrication facility.
法兰端为六角孔，不能再润滑。

• For cylindrical outer race, add the suffix "X". e.g. KR22PPX

外圈为圆柱面的轴衬加后缀“X”例如KR22PPX

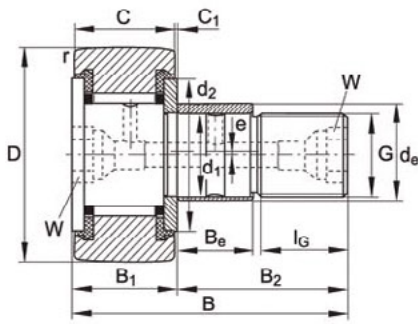

from D = 22 mm KPE..-PP R = 500 mm

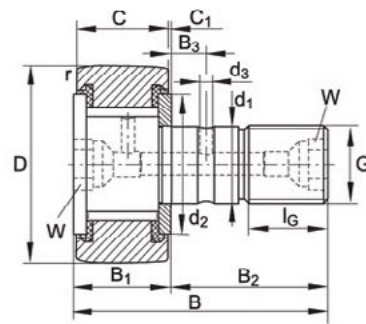

from D = 22 mm KPV..-PP R = 500 mm

d ₃	G	l _G	W	Eccentric corrlar 偏心套			油嘴 Drive fit lubrication nipple	螺母拧紧扭矩 Nut tightening torque M _A Nm	基本额定负荷 Basic load ratings		极限疲劳 载荷 Fatigue limit load C _{urw} N	极限转速 Speed n _{DG} min ⁻¹
				d _e h9	B _e	e			dyn. C _{r w} 动态 N	stat. C _{o r w} 静态 N		
-	M6(X1)	8	-	-	-	-	NIPA1	3	3150	3300	415	14000
-	M6(X1)	8	-	9	7	0.5	NIPA1	3	3150	3300	415	14000
-	M6(X1)	8	4	-	-	-	-	3	3150	3300	415	14000
-	M6(X1)	8	-	-	-	-	NIPA1	3	4900	6500	860	3800
-	M8(X1.25)	10	-	-	-	-	NIPA1	8	3500	3900	485	11000
-	M8(X1.25)	10	-	11	9	0.5	NIPA1	8	3500	3900	485	11000
-	M8(X1.25)	10	4	-	-	-	-	8	3500	3900	485	11000
-	M8(X1.25)	10	-	-	-	-	NIPA1	8	5400	7900	1040	3100
-	M10X1	12	5	-	-	-	NIPA1X4.5	15	4500	5200	650	8000
-	M10X1	12	5	13	10	0.5	NIPA1X4.5	15	4500	5200	650	8000
-	M10X1	12	5	-	-	-	NIPA1X4.5	15	6200	9100	1110	2600
-	M10X1	12	5	-	-	-	NIPA1X4.5	15	5100	6200	770	8000
-	M10X1	12	5	13	10	0.5	NIPA1X4.5	15	5100	6200	770	8000
-	M10X1	12	5	-	-	-	NIPA1X4.5	15	7300	11300	1380	2600
3	M12X1.5	13	6	-	-	-	NIPA1X4.5	22	6800	8400	1070	5500
3	M12X1.5	13	6	15	11	0.5	NIPA1X4.5	22	6800	8400	1070	5500
3	M12X1.5	13	6	-	-	-	NIPA1X4.5	22	9500	14600	1840	2100
3	M12X1.5	13	6	-	-	-	NIPA1X4.5	22	7100	8900	1140	5500
3	M12X1.5	13	6	15	11	0.5	NIPA1X4.5	22	7100	8900	1140	5500
3	M12X1.5	13	6	-	-	-	NIPA1X4.5	22	10000	15800	1990	2100

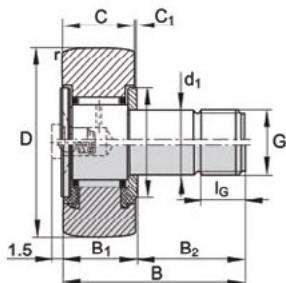

KR16, KR19
KR16-PP, KR19-PP (KRV16-PP, KRV19-PP)

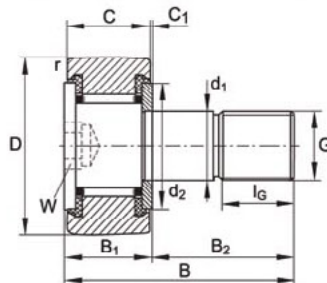

KR16- SK-PP, KR19-SK-PP

螺栓滚轮轴承 Stud Type Track Rollers

轴向引导
With axial guidance

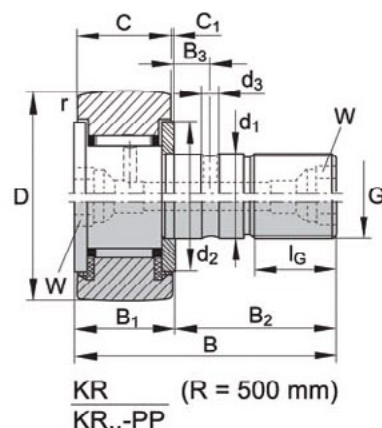
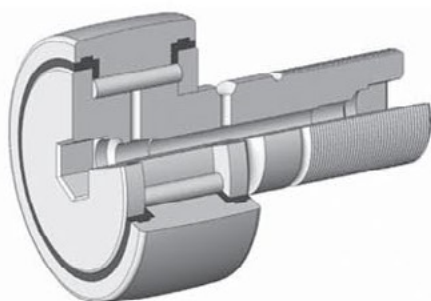

外径 Outside Diameter mm	轴承型号 Bearing Designation	质量 (克) Mass ≈ g	带偏心套型号 With eccentric collar Designation	质量 (克) Mass ≈ g	尺寸(毫米) Dimensions(mm)									
					D	d ₁ h7	B	B ₁ max.	B ₂	B ₃	C	C ₁	r min.	d ₂
35	KR35	173	-	-	35	16	52	19.6	32.5	8	18	0.8	0.6	27.6
35	KR35-PP	164	KRE35-PP	177	35	16	52	19.6	32.5	8	18	0.8	0.6	27.6
35	KRV35-PP	166	-	-	35	16	52	19.6	32.5	8	18	0.8	0.6	27.6
40	KR40	247	-	-	40	18	58	21.6	36.5	8	20	0.8	1	31.5
40	KR40-PP	239	KRE40-PP	255	40	18	58	21.6	36.5	8	20	0.8	1	31.5
40	KRV40-PP	247	-	-	40	18	58	21.6	36.5	8	20	0.8	1	31.5
47	KR47-PP	381	KRE47-PP	400	47	20	66	25.6	40.5	9	24	0.8	1	36.5
47	KRV47-PP	390	-	-	47	20	66	25.6	40.5	9	24	0.8	1	36.5
52	KR52-PP	454	KRE52-PP	473	52	20	66	25.6	40.5	9	24	0.8	1	36.5
52	KRV52-PP	463	-	-	52	20	66	25.6	40.5	9	24	0.8	1	36.5
62	KR62-PP	770	KRE62-PP	798	62	24	80	30.6	49.5	11	29	0.8	1	44
62	KRV62-PP	787	-	-	62	24	80	30.6	49.5	11	29	0.8	1	44
72	KR72-PP	1010	KRE72-PP	1038	72	24	80	30.6	49.5	11	29	0.8	1.1	44
72	KRV72-PP	1027	-	-	72	24	80	30.6	49.5	11	29	0.8	1.1	44
80	KR80-PP	1608	KRE80-PP	1665	80	30	100	37	63	15	35	1	1.1	53
80	KRV80-PP	1636	-	-	80	30	100	37	63	15	35	1	1.1	53
90	KR90-PP	1975	KRE90-PP	2032	90	30	100	37	63	15	35	1	1.1	53
90	KRV90-PP	2003	-	-	90	30	100	37	63	15	35	1	1.1	53

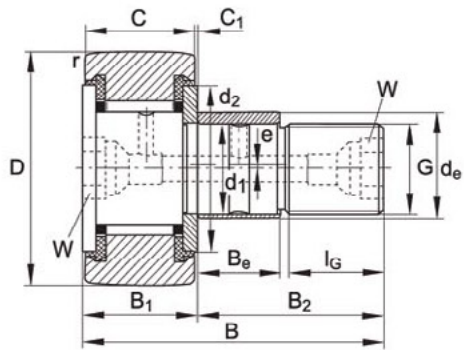

KPE..-PP

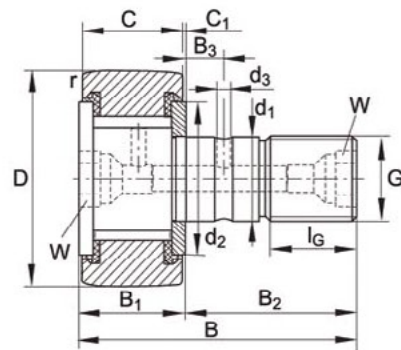

KPV..-PP

							油嘴 Drive fit lubrication nipple	螺母拧紧扭矩 Nut tightening torque M_A	基本额定负荷 Basic load ratings		极限疲劳 载荷 Fatigue limit load	极限转速 Speed
d_3	G	l_G	W	Eccentric collar 偏心套				Nm	dyn. C_{rw}	stat. C_{orw}	C_{urw}	n_{DG}
				d_e h9	B_e	e			动态 N	静态 N		
3	M16X1.5	17	8	-	-	-	NIPA2x7.5	58	9800	14100	1700	3600
3	M16X1.5	17	8	20	14	1	NIPA2x7.5	58	9800	14100	1700	3600
3	M16X1.5	17	8	-	-	-	NIPA2x7.5	58	12800	23000	2900	1600
3	M18X1.5	19	8	-	-	-	NIPA2x7.5	87	10900	15500	1850	2900
3	M18X1.5	19	8	22	15	1	NIPA2x7.5	87	10900	15500	1850	2900
3	M18X1.5	19	8	-	-	-	NIPA2x7.5	87	14800	26500	3050	1400
4	M20X1.5	21	10	24	18	1	NIPA2x7.5	120	15500	25500	3000	2400
4	M20X1.5	21	10	-	-	-	NIPA2x7.5	120	20600	42000	5200	1300
4	M20X1.5	21	10	24	18	1	NIPA2x7.5	120	16700	29000	3400	2400
4	M20X1.5	21	10	-	-	-	NIPA2x7.5	120	22600	48000	5900	2300
4	M24X1.5	25	14	28	22	1	NIPA3x9.5	220	26500	48000	6100	1900
4	M24X1.5	25	14	-	-	-	NIPA3x9.5	220	34000	75000	9800	1100
4	M24X1.5	25	14	28	22	1	NIPA3x9.5	220	28000	53000	6700	1900
4	M24X1.5	25	14	-	-	-	NIPA3x9.5	220	36500	85000	11100	1100
4	M30X1.5	32	14	35	29	1.5	NIPA3x9.5	450	39000	77000	9900	1300
4	M30X1.5	32	14	-	-	-	NIPA3x9.5	450	49500	117000	15300	850
4	M30X1.5	32	14	35	29	1.5	NIPA3x9.5	450	41000	83000	10600	1300
4	M30X1.5	32	14	-	-	-	NIPA3x9.5	450	52000	129000	16900	850

曲线滚轮(螺栓型滚轮滚针轴承)

Cam Follower(Stud Type Track Roller Bearing)

结构说明

型号说明		国外厂商		IKO	INA/SKF	Mc.GILL
有保持架 With cage	六角孔 Hex hole	圆筒外轮 Cylindrical Roller Dia.	无密封圈UNSEALED	CF..B		MCFR..BX
			带密封圈SEALED	CF..BUU		MCFR..SBX
	球面外轮Crowned Roller Dia.	无密封圈UNSEALED	CF..BR		MCFR..B	
		带密封圈SEALED	CF..BUUR	KR..PP	MCFR..SB	
	一字槽 Slotted Hole	圆筒外轮 Cylindrical Roller Dia.	无密封圈UNSEALED	CF	KR..X	MCFR..X
			带密封圈SEALED	CF..UU	KR..PPX	MCFR..SX
球面外轮Crowned Roller Dia.	无密封圈UNSEALED	CF..R	KR	MCFR..		
	带密封圈SEALED	CF..UUR	KR..PP	MCFR..S		
满装滚针 Full-complement roller	六角孔 Hex hole	圆筒外轮 Cylindrical Roller Dia.	无密封圈UNSEALED	CF..VB		MCFR..BX
			带密封圈SEALED	CF..VBUU		MCFR..SBX
	球面外轮Crowned Roller Dia.	无密封圈UNSEALED	CF..VBR		MCFR..B	
		带密封圈SEALED	CF..VBUUR	KRV..PP	MCFR..SB	
	一字槽 Slotted Hole	圆筒外轮 Cylindrical Roller Dia.	无密封圈UNSEALED	CF..V	KRV..X	MCFR..X
			带密封圈SEALED	CF..VUU	KRV..PPX	MCFR..SX
球面外轮Crowned Roller Dia.	无密封圈UNSEALED	CF..VR	KRV	MCFR..		
	带密封圈SEALED	CF..VUUR	KRV..PP	MCFR..S		

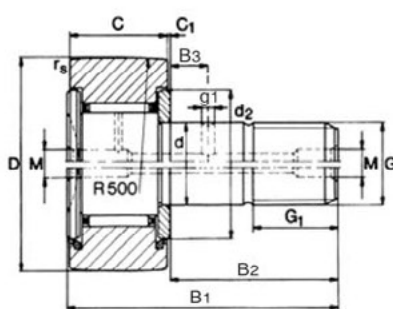

CF...BR (R = 500 mm)

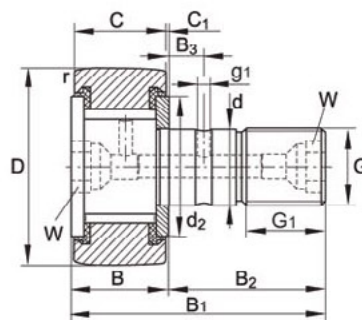

CF...VBR (R = 500 mm)

轴承型号 Bearing Designation						外形尺寸 Dimensions									
IKO	IKO	Mc.GILL		重量Mass g	重量Mass g	D	d	C	B1	B2	G	G1	M	g1	
CF 03 B			KRV10PP	5.0	KR10PP	4.5	10	3	7	17	9	M3X0.5	5	-	-
CF 04 B	CF 4 VBUUR	MCFR12SBX	KRV12PP	8.8	KR12PP	7.5	12	4	8	20	11	M4X0.7	6	-	-
CF 05 B	CF 5 VBUUR	MCFR13SBX	KRV13PP	12	KR13PP	10.5	13	5	9	23	13	M5X0.8	7.5	-	-
CF 06 B	CF 6 VBUUR	MCFR16SBX	KRV16PP	20	KR16PP	18	16	6	11	28	16	M6X1	8	-	-
CF 08 B	CF 8 VBUUR	MCFR19SBX	KRV19PP	32	KR19PP	28	19	8	11	32	20	M8X1.25	10	-	-
CF 10 B	CF 10 VBUUR	MCFR22SBX	KRV22PP	45	KR22PP	44	22	10	12	36	23	M10X1	12	-	-
CF 10-1B	CF 10-1 VBUUR	MCFR26SBX	KRV26PP	61	KR26PP	58	26		12	36	23	M10X1	12	-	-
CF 12 B	CF 12 VBUUR	MCFR30SBX	KRV30PP	89	KR30PP	87	30	12	14	40	25	M12X1.5	13	6	3
CF 12-1B	CF 12-1 VBUUR	MCFR32SBX	KRV32PP	100	KR32PP	98	32		14	40	25	M12X1.5	13	6	3
CF 16 B	CF 16 VBUUR	MCFR35SBX	KRV35PP	171	KR35PP	169	35	16	18	52	32.5	M16X1.5	17	6	3
CF 18 B	CF 18 VBUUR	MCFR40SBX	KRV40PP	249	KR40PP	247	40	18	20	58	36.5	M18X1.5	19	6	3
CF 20-1 B	CF 20-1 VBUUR	MCFR47SBX	KRV47PP	409	KR47PP	386	47	20	24	66	40.5	M20X1.5	21	8	4
CF 20 B	CF 20 VBUUR	MCFR52SBX	KRV52PP	484	KR52PP	461	52		24	66	40.5	M20X1.5	21	8	4
CF 24 B	CF 24 VBUUR	MCFR62SBX	KRV62PP	802	KR62PP	790	62	24	29	80	49.5	M24X1.5	25	8	4
CF 24-1B	CF 24-1 VBUUR	MCFR72SBX	KRV72PP	1045	KR72PP	1040	72		29	80	49.5	M24X1.5	25	8	4
CF 30 B	CF 30 VBUUR	MCFR80SBX	KRV80PP	1561	KR80PP	1550	80	30	35	100	63	M30X1.5	32	8	4
CF 30-1B	CF 30-1 VBUUR	MCFR85SBX	KRV85PP	1766	KR85PP	1750	85		35	100	63	M30X1.5	32	8	4
CF 30-2B	CF 30-2 VBUUR	MCFR90SBX	KRV90PP	1970	KR90PP	1950	90	35	100	63	M30X1.5	32	8	4	

曲线滚轮(螺栓型滚轮滚针轴承) Cam Follower(Stud Type Track Roller Bearing)

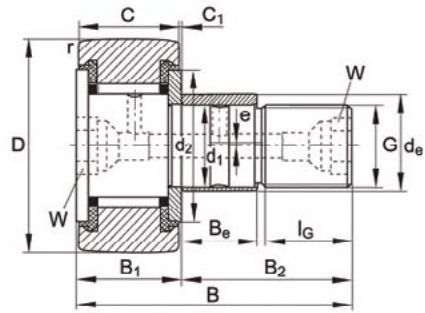

KRE、KRVE...PP (R=500)

外径 Outside Diameter mm	轴承型号 Bearing Designation 带偏心套 ¹⁾	重量 Mass Kg	外形尺寸(mm) Boundary Dimensions											基本额定负荷 Basic load Rating				极限转速 Limiting Speed rpm	
			D	d1	C	B	B2	G	LG	C1	de	Be	e	M	作为支承滚轮				
			动 Cw	动 Cw	静 Cow	静 Cow													
16	KRE 16	0.023	16	6	11	28	16	M 6	8	0.6	9	7	0.5	3	3800	3750	3150	3300	22000
	KRE 16 PP		16	6	11	28	16	M 6	8	0.6	9	7	0.5	3	3800	3750	3150	3300	16000
	KRVE 16		16	6	11	28	16	M 6	8	0.6	9	7	0.5	3	6400	8500	4850	6500	8500
	KRVE16 PP		16	6	11	28	16	M 6	8	0.6	9	7	0.5	3	6400	8500	4850	6500	8500
19	KRE19	0.032	19	8	11	32	20	M 8	10	0.6	11	9	0.5	8	4250	4600	3500	3900	20000
	KRE 19 PP		19	8	11	32	20	M 8	10	0.6	11	9	0.5	8	4250	4600	3500	3900	14000
	KRVE 19		19	8	11	32	20	M 8	10	0.6	11	9	0.5	8	7300	10800	5500	7900	7000
	KRVE 19 PP		19	8	11	32	20	M 8	10	0.6	11	9	0.5	8	7300	10800	5500	7900	7000
22	KRE 22	0.050	22	10	12	36	23	M 10 × 1	12	0.6	13	10	0.5	15	5700	6500	4450	5200	16000
	KRE 22 PP		22	10	12	36	23	M 10 × 1	12	0.6	13	10	0.5	15	5700	6500	4450	5200	11000
	KRVE 22		22	10	12	36	23	M 10 × 1	12	0.6	13	10	0.5	15	8600	12900	6300	9100	6000
	KRVE 22 PP		22	10	12	36	23	M 10 × 1	12	0.6	13	10	0.5	15	8600	12900	6300	9100	6000
26	KRE 26	0.063	26	10	12	36	23	M 10 × 1	12	0.6	13	10	0.5	15	5700	6500	5100	6200	16000
	KRE 26 PP		26	10	12	36	23	M 10 × 1	12	0.6	13	10	0.5	15	5700	6500	5100	6200	11000
	KRVE 26		26	10	12	36	23	M 10 × 1	12	0.6	13	10	0.5	15	8600	12900	7300	11300	6000
	KRVE 26 PP		26	10	12	36	23	M 10 × 1	12	0.6	13	10	0.5	15	8600	12900	7300	11300	6000
30	KRE 30	0.095	30	12	14	40	25	M 12 × 1.5	13	0.6	15	11	0.5	22	8100	9700	6800	8400	11000
	KRE 30 PP		30	12	14	40	25	M 12 × 1.5	13	0.6	15	11	0.5	22	8100	9700	6800	8400	8300
	KRVE 30		30	12	14	40	25	M 12 × 1.5	13	0.6	15	11	0.5	22	12200	19000	9500	14600	4500
	KRVE 30 PP		30	12	14	40	25	M 12 × 1.5	13	0.6	15	11	0.5	22	12200	19000	9500	14600	4500
32	KRE 32	0.104	32	12	14	40	25	M 12 × 1.5	13	0.6	15	11	0.5	22	8100	9700	7100	9000	11000
	KRE 32PP		32	12	14	40	25	M 12 × 1.5	13	0.6	15	11	0.5	22	8100	9700	7100	9000	8300
	KRVE 32		32	12	14	40	25	M 12 × 1.5	13	0.6	15	11	0.5	22	12200	19000	10000	15800	4500
	KRVE 32 PP		32	12	14	40	25	M 12 × 1.5	13	0.6	15	11	0.5	22	12200	19000	10000	15800	4500
35	KRE 35	0.177	35	16	18	52	32.5	M 16 × 1.5	17	0.8	20	14	1	58	12900	19000	9700	14100	7000
	KRE 35 PP		35	16	18	52	32.5	M 16 × 1.5	17	0.8	20	14	1	58	12900	19000	9700	14100	7000
	KRVE 35		35	16	18	52	32.5	M 16 × 1.5	17	0.8	20	14	1	58	18300	35000	12800	23000	3400
	KRVE 35 PP		35	16	18	52	32.5	M 16 × 1.5	17	0.8	20	14	1	58	18300	35000	12800	23000	3400
	NUKRE 35		35	16	18	52	32.5	M 16 × 1.5	17	0.8 ⁴⁾	20	14	1	58	23000	27000	16000	18300	6500
40	KRE 40	0.255	40	18	20	58	36.5	M 18 × 1.5	19	0.8	22	16	1	87	14200	20400	10900	15500	6000
	KRE 40 PP		40	18	20	58	36.5	M 18 × 1.5	19	0.8	22	16	1	87	14200	20400	10900	15500	6000
	KRVE 40		40	18	20	58	36.5	M 18 × 1.5	19	0.8	22	16	1	87	21000	39500	14800	26500	2900
	KRVE 40 PP		40	18	20	58	36.5	M 18 × 1.5	19	0.8	22	16	1	87	21000	39500	14800	26500	2900
	NUKRE 40		40	18	20	58	36.5	M 18 × 1.5	19	0.8 ⁴⁾	22	16	1	87	24800	31000	18500	22800	5500

■ 1) 后缀“X”表示为圆柱形外表面。 2) 当轴承外圈(有外圆柱表面)装入具有一般轴承配合的座孔中时,使用基本额定负荷C和Co;当用作滚轮时,使用额定负荷Cw和Cow。 3) 使用油润滑时,转速增加约30%,带密封的情况下例外。 4) NUKRE 35 B1=31.5; C1=1.8; d2=24; NUKRE40 B1=35.5; C1=1.8; d2=26.5)油孔仅在螺栓挡边端端面上。

有轴向引导支承滚轮

Yoke Type Track Rollers Without Sealed and with axial guiding

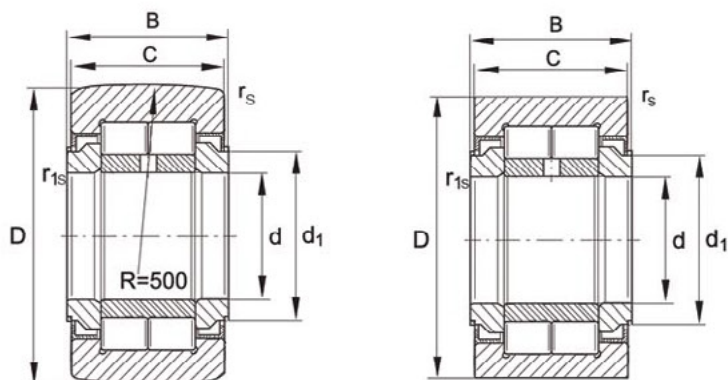

NUTR

NUTR...X

外径 Outside Diameter	轴承型号 Bearing Designation	重量 Mass	外形尺寸 Boundary Dimensions					基本额定负荷 Basic Load Rating				极限转速 ¹⁾ Limiting Speed n _{lgrease} ≈ min ⁻¹		
			d	D	B	C	d ₁	动C _{r1} Dynamic	静C _{or} Static	作为支承滚轮 Yoke Type Track				
mm		g	mm					N		动C _w	静C _{ow}	F _{r perm}	F _{or perm}	
35	NUTR 15	99	15	35	19	18	20	23000	27000	16000	183000	8300	16400	6500
40	NUTR 17	147	17	40	21	20	22	24800	31000	18500	22800	13200	22800	5500
42	NUTR 1542	158	15	42	19	18	20	23000	27000	19400	23800	23900	23900	6500
	NUTR 1747	220	17	47	21	20	22	24800	31000	21300	28000	28000	28000	5500
47	NUTR 20	245	20	47	25	24	27	39000	50000	28000	35000	16500	33000	4200
	NUTR 2052	321	20	52	25	24	27	39000	50000	31500	41000	38500	41000	4200
52	NUTR 25	281	25	52	25	24	31	43500	60000	29000	37500	17300	34500	3400
	NUTR 2562	450	25	62	25	24	31	43500	60000	35500	50000	50000	50000	3400
62	NUTR 30	465	30	62	29	28	38	59000	79000	40000	51000	23600	47000	2600
	NUTR 3072	697	30	72	29	28	38	59000	79000	48000	65000	65000	65000	2600
72	NUTR 35	630	35	72	29	28	44	65000	93000	45000	61000	32000	61000	2100
	NUTR 3580	838	35	80	29	28	44	65000	93000	51000	72000	72000	72000	2100
80	NUTR 40	816	40	80	32	30	51	90000	134000	56000	76000	30500	60000	1600
	NUTR 45	883	45	85	32	30	55	98000	147000	56000	79000	31500	61000	1400
90	NUTR 4090	1129	40	90	32	30	51	90000	134000	66000	96000	84000	96000	1600
	NUTR 50	950	50	90	32	30	60	100000	161000	57000	81000	32000	63000	1300
100	NUTR 45100	1396	45	100	32	30	55	95000	147000	72000	108000	106000	108000	1400
110	NUTR 50110	1690	50	110	32	30	60	100000	161000	76000	121000	121000	121000	1300

■ 1) 后缀“X”表示圆柱形外表面。2) 当轴承外圈(有外圆柱表面)装入具有一般轴承配合的座孔中时, 使用基本额定负荷C和C₀; 当用作滚轮时, 使用额定负荷C_w和C_{ow} 3) 使用油润滑时, 转速增加约30%。带密封的情况下例外。

1) suffix “X” means the outer surface of the cylinder. 2) when the bearing outer ring (with outer cylindrical surface) is fitted with general bearings in the seat holes, basic stable load C and C₀ should be used while used as rolling wheel. rated load C_w and C_{ow} 3) should be used. but the rotating speed will increase by about 30% if oil lubricant is used.

支撑滚轮轴承

Yoke Type Track Rollers

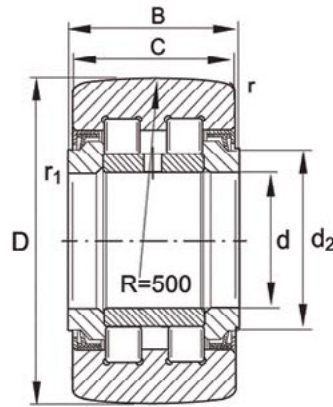

PWTR..-2RS

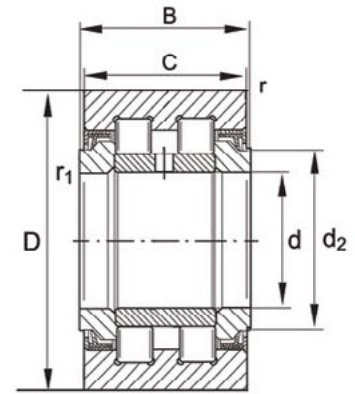

PWTR..-2RS...X

外径 Outside Diameter	轴承型号 Bearing Designation	重量 Mass	外形尺寸 Boundary Dimensions					基本额定负荷 Basic Load Rating							极限转速 ³⁾ Limiting Speed n _{lgrease} ≈ min ⁻¹
			d	D	B	C	d ₁	动C _{r1} Dynamic	静C _{or} Static	作为支承滚轮 Yoke Type Track					
			mm					N		动C _w	静C _{ow}	F _{r perm}	F _{or perm}		
35	PWTR15-2RS	99	15	35	19	18	20	23000	27000	16000	183000	8300	16400	6500	
40	PWTR17-2RS	147	17	40	21	20	22	24800	31000	18500	22800	13200	22800	5500	
42	PWTR1542-2RS	158	15	42	19	18	20	23000	27000	19400	23800	23900	23900	6500	
47	PWTR1747-2RS	220	17	47	21	20	22	24800	31000	21300	28000	28000	28000	5500	
	PWTR20-2RS	245	20	47	25	24	27	39000	50000	28000	35000	16500	33000	4200	
52	PWTR2052-2RS	321	20	52	25	24	27	39000	50000	31500	41000	38500	41000	4200	
	PWTR25-2RS	281	25	52	25	24	31	43500	60000	29000	37500	17300	34500	3400	
62	PWTR2562-2RS	450	25	62	25	24	31	43500	60000	35500	50000	50000	50000	3400	
	PWTR30-2RS	465	30	62	29	28	38	59000	79000	40000	51000	23600	47000	2600	
72	PWTR3072-2RS	697	30	72	29	28	38	59000	79000	48000	65000	65000	65000	2600	
	PWTR35-2RS	630	35	72	29	28	44	65000	93000	45000	61000	32000	61000	2100	
80	PWTR3580-2RS	838	35	80	29	28	44	65000	93000	51000	72000	72000	72000	2100	
	PWTR40-2RS	816	40	80	32	30	51	90000	134000	56000	76000	30500	60000	1600	
85	PWTR45-2RS	883	45	85	32	30	55	98000	147000	56000	79000	31500	61000	1400	
90	PWTR4090-2RS	1129	40	90	32	30	51	90000	134000	66000	96000	84000	96000	1600	
	PWTR50-2RS	950	50	90	32	30	60	100000	161000	57000	81000	32000	63000	1300	
100	PWTR45100-2RS	1396	45	100	32	30	55	95000	147000	72000	108000	106000	108000	1400	
110	PWTR50110-2RS	1690	50	110	32	30	60	100000	161000	76000	121000	121000	121000	1300	

■ 1)后缀“X”表示圆柱形外表面。2)当轴承外圈(有外圆柱表面)装入具有一般轴承配合的座孔中时,使用基本定负荷C和C_o;当用作滚轮时,使用额定负荷C_w和C_{ow} 3)使用油润滑时,转速增加约30%。带密封的情况下例外。

1)suffix “X” means the outer surface of the cylinder. 2)when the bearing outer ring(with outer cylindrical surface)is fired with general bearings in the seat holes. basic stable load C and C_o should be used while used as rolling wheel. rated load C_w and C_{ow} 3)should be used. bthe rotating speed will increase by about 30%if oil lubricant is used.

开式可分离滚轮轴承

Separable Roller Followers, Open Type With Cage/With Inner Ring

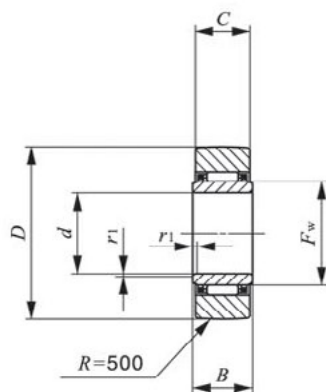

NAST...R

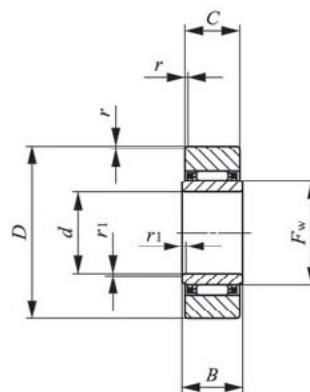

NAST

Shaft dia. 6 – 50mm

轴径 Shaft dia. mm	轴承型号 Identification number 开式 Open type		重量 Mass (Ref.) g	尺寸 Boundary dimensions mm							基本额定 动负荷 Basic dynamic load rating C N	基本额定 静负荷 Basic static load rating Co N	配套内圈 Assembled inner ring
	圆弧外圈 Crowned outer ring	圆柱外圈 Cylindrical outer ring		d	D	B	C	$r_s^{(1)}$ min	$r_{1s}^{(1)}$ min	F _w			
6	NAST 6 R	NAST 6	17.8	6	19	10	9.8	0.3	0.3	10	4 160	4 550	LRT 61010 S
8	NAST 8 R	NAST 8	28	8	24	10	9.8	0.6	0.3	12	5 650	5 890	LRT 81210 S
10	NAST 10 R	NAST 10	49.5	10	30	12	11.8	1	0.3	14	9 790	9 680	LRT 101412 S
12	NAST 12 R	NAST 12	58	12	32	12	11.8	1	0.3	16	10 500	10 900	LRT 121612 S
15	NAST 15 R	NAST 15	62	15	35	12	11.8	1	0.3	20	12 400	14 300	LRT 152012 S
17	NAST 17 R	NAST 17	109	17	40	16	15.8	1	0.3	22	17 600	20 900	LRT 172216 S
20	NAST 20 R	NAST 20	157	20	47	16	15.8	1	0.3	25	19 400	24 500	LRT 202516 S
25	NAST 25 R	NAST 25	180	25	52	16	15.8	1	0.3	30	20 800	28 400	LRT 253016 S
30	NAST 30 R	NAST 30	320	30	62	20	24.8	1	0.6	38	30 500	45 400	LRT 303820 S
35	NAST 35 R	NAST 35	440	35	72	20	24.8	1	0.6	42	32 400	50 600	LRT 354220 S
40	NAST 40 R	NAST 40	530	40	80	20	25.8	1.5	1	50	35 900	61 100	LRT 405020 S
45	NAST 45 R	NAST 45	580	45	85	20	25.8	1.5	1	55	37 400	66 400	LRT 455520 S
50	NAST 50 R	NAST 50	635	50	90	20	25.8	1.5	1	60	38 900	71 700	LRT 506020 S

 Note⁽¹⁾ Minimum allowable value of chamfer dimension r or r_1

Remarks 1. No oil hole is provided.

2. Not provided with prepacked grease. Perform proper lubrication for use.

 1N=0.102kgf=0.2248lbs.
 1mm=0.03937inch

闭式可分离滚轮轴承

Separable Roller Followers, Shield Type
With Cage/With Inner Ring

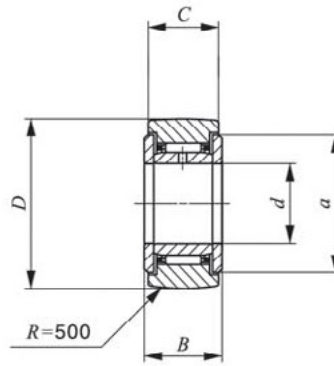

NAST ... ZZR

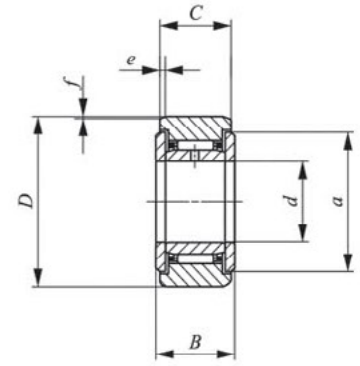

NAST ... ZZ

密封型可分离滚轮轴承

Separable Roller Followers, Sealed Type
With Cage/With Inner Ring

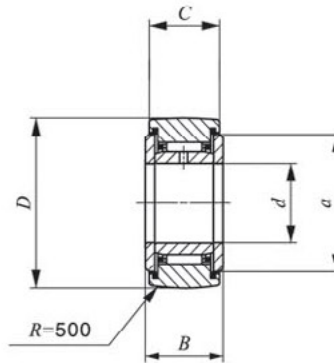

NAST ... ZZUUR

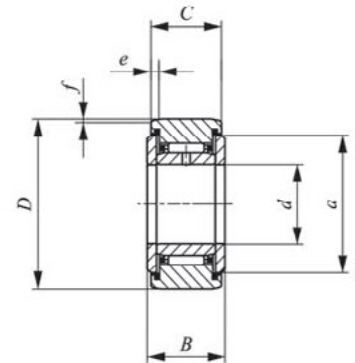

NAST ... ZZUU

Shaft dia. 6 – 50mm

轴径 Shaft dia. mm	轴承型号 Identification number				重量 Mass (Ref.) g	尺寸 Boundary dimensions mm							基本额定 动负荷 Basic dynamic load rating C N	基本额定 静负荷 Basic static load rating Co N
	闭式 Shield type		密封型 Sealed type			d	D	B	C	a	e	f		
	圆弧外圈 Crowned outer ring	圆柱外圈 Cylindrical outer ring	圆弧外圈 Crowned outer ring	圆柱外圈 Cylindrical outer ring										
6	NAST 6 ZZR	NAST 6 ZZ	NAST 6 ZZUUR	NAST 6 ZZUU	24.5	6	19	14	13.8	14	2.5	0.8	4 160	4 550
8	NAST 8 ZZR	NAST 8 ZZ	NAST 8 ZZUUR	NAST 8 ZZUU	39	8	24	14	13.8	17.5	2.5	0.8	5 650	5 890
10	NAST 10 ZZR	NAST 10 ZZ	NAST 10 ZZUUR	NAST 10 ZZUU	65	10	30	16	15.8	23.5	2.5	0.8	9 790	9 680
12	NAST 12 ZZR	NAST 12 ZZ	NAST 12 ZZUUR	NAST 12 ZZUU	75	12	32	16	15.8	25.5	2.5	0.8	10 500	10 900
15	NAST 15 ZZR	NAST 15 ZZ	NAST 15 ZZUUR	NAST 15 ZZUU	83	15	35	16	15.8	29	2.5	0.8	12 400	14 300
17	NAST 17 ZZR	NAST 17 ZZ	NAST 17 ZZUUR	NAST 17 ZZUU	135	17	40	20	19.8	32.8	3	1	17 600	20 900
20	NAST 20 ZZR	NAST 20 ZZ	NAST 20 ZZUUR	NAST 20 ZZUU	195	20	47	20	19.8	38	3	1	19 400	24 500
25	NAST 25 ZZR	NAST 25 ZZ	NAST 25 ZZUUR	NAST 25 ZZUU	225	25	52	20	19.8	43	3	1	20 800	28 400
30	NAST 30 ZZR	NAST 30 ZZ	NAST 30 ZZUUR	NAST 30 ZZUU	400	30	62	25	24.8	50.5	4	1.2	30 500	45 400
35	NAST 35 ZZR	NAST 35 ZZ	NAST 35 ZZUUR	NAST 35 ZZUU	550	35	72	25	24.8	53.5	4	1.2	32 400	50 600
40	NAST 40 ZZR	NAST 40 ZZ	NAST 40 ZZUUR	NAST 40 ZZUU	710	40	80	26	25.8	61.5	4	1.2	35 900	61 100
45	NAST 45 ZZR	NAST 45 ZZ	NAST 45 ZZUUR	NAST 45 ZZUU	760	45	85	26	25.8	66.5	4	1.2	37 400	66 400
50	NAST 50 ZZR	NAST 50 ZZ	NAST 50 ZZUUR	NAST 50 ZZUU	830	50	90	26	25.8	76	4	1.2	38 900	71 700

Remarks1. The inner ring has an oil hole.

2. The sealed type is provided with prepacked grease. The shield type is not provided with prepacked grease. Perform proper lubrication for use.

1N=0.102kgf=0.2248lbs.
1mm=0.03937inch

无内圈滚针轴承

Needle Roller Bearings Without Inner Rings

NK, NKS,
RNA49, RNA69, RNA48

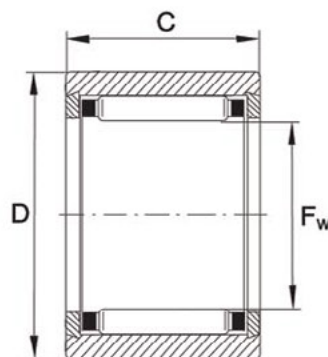

NK ($F_w \leq 10 \text{ mm}$)

轴径 Shaft Diameter mm	轴承型号 Bearing Designation	质量(克) Mass ≈ g	尺寸(毫米) Dimensions (mm)				基本额定负荷 Basic load ratings				极限疲劳载荷 Fatigue limit load C_{ur} N	极限转速 Limiting speed n_c min ⁻¹	参考转速 Reference speed n_b min ⁻¹
			F_w	D	C	r min.	dyn. C_r N	动态	stat. C_{or} N	静态			
5	NK5/10-TV ¹⁾	3.1	5	10	10	0.15	2 650		1 920		295	36 500	33 500
5	NK5/12-TV ¹⁾	3.7	5	10	12	0.15	3 400		2 650		435	36 500	32 500
6	NK6/10-TV ¹⁾	4.7	6	12	10	0.15	2 950		2 280		355	33 500	31 500
6	NK6/12-TV ¹⁾	5.7	6	12	12	0.15	3 800		3 150		520	33 500	31 000
7	NK7/10-TV ¹⁾	6.9	7	14	10	0.3	3 250		2 650		410	31 000	30 000
7	NK7-12TV ¹⁾	8.2	7	14	12	0.3	4 150		3 600		600	31 000	29 500
8	NK8/12-TV ¹⁾	8.7	8	15	12	0.3	4 450		4 100		690	29 500	27 000
8	NK8/16-TV ¹⁾	12	8	15	16	0.3	5 800		5 800		970	29 500	26 500
9	NK9/12-TV ¹⁾	10.3	9	16	12	0.3	5 100		5 000		840	28 500	24 200
9	NK9/16-TV ¹⁾	12.8	9	16	16	0.3	6 600		7 100		1 190	28 500	23 900
10	NK10/12-TV ¹⁾	10.1	10	17	12	0.3	5 300		5 500		930	27 000	22 300
10	NK10/16-TV ¹⁾	13.3	10	17	16	0.3	7 000		7 800		1 310	27 000	22 000
12	NK12/12	12.1	12	19	12	0.3	7 200		7 100		1 280	25 500	19 000
12	NK12/16	15.9	12	19	16	0.3	10 100		11 000		1 920	25 500	18 400
14	NK14/16	20.7	14	22	16	0.3	11 400		11 500		2 100	23 600	16 100
14	NK14/20	25.5	14	22	20	0.3	14 500		15 600		2 700	23 600	15 900
14	RNA4900	16.5	14	22	13	0.3	9 600		9 200		1 630	23 600	15 400
15	NK15/16	21.8	15	23	16	0.3	12 100		12 700		2 320	22 900	15 200
15	NK15/250	26.6	15	23	20	0.3	15 400		17 200		3 000	22 900	14 900
16	NK16/16	22.4	16	24	16	0.3	12 800		13 900		2 550	22 400	14 300
16	NK16/20	28.4	16	24	20	0.3	16 300		18 800		3 250	22 400	14 000
16	RNA4901	17.4	16	24	13	0.3	10 600		10 900		1 940	22 400	13 500
16	RNA69014	31	16	24	22	0.3	18 100		21 600		3 800	22 400	12 600
17	NK17/16	23.7	17	25	16	0.3	13 500		15 000		2 750	21 800	13 600
17	NK17/20	29.8	17	25	20	0.3	17 100		20 400		3 550	21 800	13 300
18	NK18/16	24.9	18	26	16	0.3	14 100		16 200		3 000	21 300	12 900
18	NK18/20	31.4	18	26	20	0.3	17 900		22 000		3 850	21 300	12 600
19	NK19/16	26.1	19	27	16	0.3	14 700		17 400		3 200	20 900	12 300
19	NK19/20	32.2	19	27	20	0.3	18 700		13 600		4 150	20 900	12 000

¹⁾ With closing rings, without lubrication hole and groove. 双挡圈, 无润滑油孔和油槽。

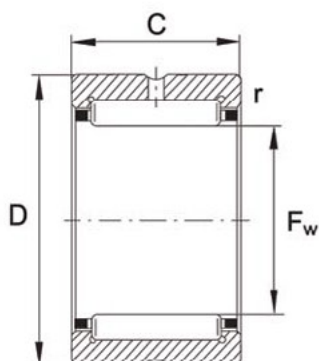

NK ($F_w \geq 12$ mm),
RNA49, RNA69

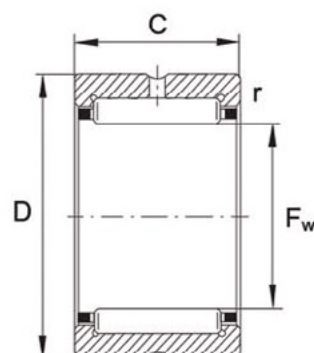

NK, NKS, RNA49, RNA69

轴径 Shaft Diameter mm	轴承型号 Bearing Designation	质量 (克) Mass ≈ g	尺寸(毫米) Dimensions (mm)				基本额定负荷 Basic load ratings		极限疲劳 载荷 Fatigue limit load C_{ur} N	极限转速 Limiting speed n_c min ⁻¹	参考转速 Reference speed n_b min ⁻¹
			F_w	D	C	r min.	dyn. C_r N 动态	stat. C_{or} N 静态			
20	NK20/16	27	20	28	16	0.3	14600	17500	3200	20400	11900
20	NK20/20	33.9	20	28	20	0.3	18600	23800	4150	20400	11600
20	RNA4902	21.7	20	28	13	0.3	12000	13600	2430	20400	10800
20	RNA6902	39.7	20	28	23	0.3	19500	25500	4450	20400	10600
20	NKS20	48.7	20	32	20	0.6	26000	25000	4400	18800	10700
21	NK21/16	28.1	21	29	16	0.3	15200	18700	3450	19600	11400
21	NK21/20	35.2	21	29	20	0.3	19300	25500	4450	19600	11100
22	NK22/16	30	22	30	16	0.3	15800	19900	3650	18800	10900
22	NK22/20	37	22	30	20	0.3	20000	27000	4700	18800	10700
22	RNA4903	22.2	22	30	13	0.3	12400	14600	2600	18800	9900
22	RNA6903	42.4	22	30	23	0.3	21100	29000	5100	18800	9500
22	NKS22	61.5	22	35	20	0.6	27500	28000	4900	17200	9700
24	NK24/16	31.9	24	32	16	0.3	16900	22300	4100	17500	10100
24	NK24/20	40	24	32	20	0.3	21400	30500	5300	17500	9800
24	NKS24	65.5	24	37	20	0.6	29500	31000	5400	16100	9100
25	NK25/16	32.6	25	33	16	0.3	16800	22400	4150	16900	9800
25	NK25/20	42	25	33	20	0.3	21300	30500	5300	16900	9600
25	RNA4904	52.3	25	37	17	0.3	23700	25500	4600	15800	8900
25	RNA6904	100	25	37	30	0.3	40500	51000	9100	15800	8500
25	NKS25	68.1	25	38	20	0.6	31000	33500	5800	15600	8700
26	NK26/16	34	26	34	16	0.3	17300	23600	4350	16300	9500
26	NK26/20	42	26	34	20	0.3	22000	32000	5600	16300	9300
28	NK28/20	52.2	28	37	20	0.3	24800	34000	5900	15100	8600
28	NK28/30	82	28	37	30	0.3	37000	57000	10500	15100	8400
28	RNA49/22	50.2	28	39	17	0.3	26000	29500	5300	14600	8000
28	RNA69/22	98	28	39	30	0.3	42000	55000	9900	14600	7800
28	NKS28	83.6	28	42	20	0.6	32500	36500	6400	14000	7900
29	NK29/20	50	29	38	20	0.3	27500	39000	6800	14600	8500
29	NK29/30	84.3	29	38	30	0.3	37000	57000	10600	14600	8100
30	NK30/20	61	30	40	20	0.3	28000	41000	7200	14600	8200
30	NK30/30	92.4	30	40	30	0.3	42000	69000	12700	14000	7500
30	RNA4905	61	30	42	17	0.3	26500	31500	5700	13600	7400
30	RNA6905	112	30	42	30	0.3	44000	59000	10600	13600	7200
30	NKS30	104	30	45	22	0.6	36500	40000	6900	13100	7600

无内圈滚针轴承

Needle Roller Bearings Without Inner Rings

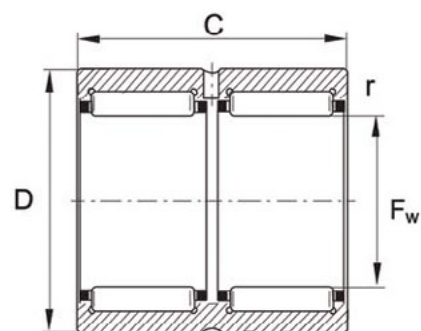

RNA69...ZW $F_w \geq 40$ mm

轴径 Shaft Diameter mm	轴承型号 Bearing Designation	质量 (克) Mass ≈ g	尺寸(毫米) Dimensions (mm)				基本额定负荷 Basic load ratings		极限疲劳 载荷 Fatigue limit load C_{ur} N	极限转速 Limiting speed n_G min^{-1}	参考转速 Reference speed n_B min^{-1}
			F_w	D	C	r	dyn. C_r 动 N 态	stat. C_{or} 静 N 态			
32	NK32/20	64	32	42	20	0.3	29 500	44 500	7 800	13 200	7 700
32	NK32/30	102	32	42	30	0.3	39 000	63 000	11 700	13 200	7 500
32	RNA49/28	73,2	32	45	17	0.3	27 500	33 500	6 100	12 700	6 900
32	RNA69/28	135	32	45	30	0.3	45 500	63 000	11 400	12 700	6 700
32	NKS32	110	32	47	22	0.6	38 000	43 500	7 400	12 400	7 200
35	NK35/20	69,4	35	45	20	0.3	31 000	48 500	8 500	12 300	6 800
35	NK35/30	106	35	45	30	0.3	46 000	81 000	15 000	12 300	6 600
35	RNA4906	69,4	35	47	17	0.3	28 500	35 500	6 400	12 000	6 400
35	RNA6906	126	35	47	30	0.3	49 000	71 000	12 900	12 000	6 100
35	NKS35	118	35	50	22	0.6	39 500	47 000	8 000	11 500	6 700
37	NK37/20	77	37	47	20	0.3	28 000	43 500	7 600	11 700	6 900
37	NK37/30	113	37	47	30	0.3	42 000	73 000	13 500	11 700	6 600
37	NKS37	123	37	52	22	0.6	41 500	50 000	8 600	11 000	6 400
38	NK38/20	79,4	38	48	20	0.3	29 000	45 000	7 900	11 400	6 700
38	NK38/30	116	38	48	30	0.3	43 000	76 000	14 000	11 400	6 500
40	NK40/20	78	40	50	20	0.3	33 500	56 000	9 800	10 900	6 100
40	NK40/30	125	40	50	30	0.3	44 000	79 000	14 600	10 900	6 200
40	RNA49/32	89,1	40	52	20	0.6	34 500	47 500	8 900	10 700	6 000
40	RNA69/32-ZW	162	40	52	36	0.6	53 000	82 000	15 100	10 700	6 000
40	NKS40	129	40	55	22	0.6	42 500	54 000	9 200	10 300	6 100
42	NK42/20	85,8	42	52	20	0.3	30 000	49 000	8 600	10 400	6 200
42	NK42/302	130	42	52	30	0.3	44 500	82 000	15 200	10 400	6 000
42	RNA4907	107	42	55	20	0.6	35 500	50 000	9 400	10 100	5 600
42	RNA6907-ZW	193	42	55	36	0.6	54 000	86 000	15 900	10 100	5 700
43	NK43/20	86	43	53	20	0.3	30 500	51 000	8 900	10 200	6 000
43	NK43/30	133	43	53	30	0.3	45 500	85 000	15 800	10 200	5 900
43	NKS43	139	43	58	22	0.6	44 000	57 000	9 800	9 700	5 800
45	NK45/20	85,3	45	55	20	0.3	35 000	62 000	10 800	9 800	5 600
45	NK45/30	132	45	55	30	0.3	52 000	103 000	19 100	9 800	5 400
45	NKS45	145	45	60	22	0.6	45 500	60 000	10 400	9 300	5 600
47	NK47/20	94,5	47	57	20	0.3	32 500	56 000	9 900	9 400	5 600
47	NK47/30	142	47	57	30	0.3	48 500	94 000	17 500	9 400	5 400
48	RNA4908	140	48	62	22	0.6	48 500	67 000	11 500	8 900	5 000
48	RNA6908-ZW	256	48	62	40	0.6	74 000	116 000	19 400	8 900	5 100

* TN=塑料保险架, 允许运转温度: 120°C连续地, 150°C临时地, 180°C短时地。†) 对于脂润滑, 允许值为表列数值的60%。*有挡圈, 无润滑油孔和槽, 如需要油孔和槽时, 需在轴承代号上增加ASR1。
 TN=plastic retainer, permissible operational temperature 120°C, 150°C for temporary use, 180°C for shorttime only †) for grease lub, the permissible value should be 60% of those in the list. with retaining ring, no lubricating holes or grooves, please add ASR1 before the bearing code if oil holes or grooves are needed for your products.

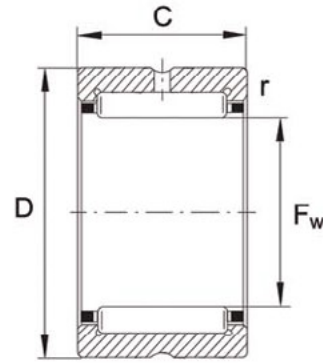

NK , NKS, RNA49, RNA69

轴径 Shaft Diameter mm	轴承型号 Bearing Designation	质量 (克) Mass ≈ g	尺寸(毫米) Dimensions (mm)				基本额定负荷 Basic load ratings		极限疲劳 载荷 Fatigue limit load C _{ur} N	极限转速 Limiting speed n _G min ⁻¹	参考转速 Reference speed n _B min ⁻¹
			F _w	D	C	r	dyn. C _r 动态 N	stat. C _{or} 静态 N			
50	NK50/25	146	50	62	25	0.6	48 500	87 000	14 800	8 800	5 000
50	NK50/35	207	50	62	35	0.6	67 000	132 000	23 900	8 800	4 900
50	NKS50	157	50	65	22	1	48 000	67 000	11 500	8 500	5 100
52	RNA4909	182	52	68	22	0.6	51 000	73 000	12 600	8 200	4 550
52	RNA6909-ZW	338	52	68	40	0.6	79 000	127 000	21 400	8 200	4 600
55	NK55/25	180	55	68	25	0.6	45 500	82 000	14 000	8 000	4 850
55	NK55/35	250	55	68	35	0.6	60 000	118 000	21 300	8 000	4 800
55	NKS55	221	55	72	22	1	51 000	74 000	12 700	7 700	4 700
58	RNA4910	163	58	72	22	0.6	53 000	80 000	13 800	7 500	4 100
58	RNA6910-ZW	310	58	72	40	0.6	82 000	139 000	23 400	7 500	4 150
60	NK60/25	170	60	72	25	0.6	53 000	103 000	17 500	7 400	4 350
60	NK60/35	258	60	72	35	0.6	63 000	130 000	23 500	7 400	4 500
60	NKS60	335	60	80	28	1.1	71 000	98 000	17 300	7 000	4 350
63	RNA4911	255	63	80	25	1	65 000	100 000	17 300	6 900	3 900
63	RNA6911-ZW	470	63	80	45	1	102 000	176 000	30 000	6 900	3 900
65	NK65/25	221	65	78	25	0.6	50 000	98 000	16 700	6 900	4 250
65	NK65/35	310	65	78	35	0.6	66 000	142 000	25 500	6 900	4 200
65	NKS65	356	65	85	28	1	75 000	108 000	19 100	6 500	4 100
68	NK68/25	241	68	82	25	1	49 500	89 000	15 200	6 500	4 250
68	NK68/35	338	68	82	35	0.6	70 000	139 000	25 500	6 500	4 100
68	RNA4912	275	68	85	25	0.6	68 000	108 000	18 800	6 400	3 600
68	RNA6912-ZW	488	68	85	45	1.1	106 000	191 000	32 500	6 400	3 600
70	NK70/25	260	70	85	25	0.6	50 000	92 000	15 700	6 300	4 100
70	NK70/35	370	70	85	35	0.6	71 000	144 000	26 500	6 300	4 000
70	NKS70	380	70	90	28	1.1	77 000	113 000	20 000	6 100	3 900
72	RNA4913	312	72	90	25	1	69 000	112 000	19 500	6 000	3 400
72	RNA6913-ZW	580	72	90	45	1	108 000	198 000	33 500	6 000	3 400
73	NK73/25	302	73	90	25	1	60 000	100 000	17 500	6 000	3 900
73	NK73/35	428	73	90	35	1	85 000	156 000	27 000	6 000	3 750
75	NK75/25	315	75	92	25	1	61 000	104 000	18 200	5 900	3 800
75	NK75/35	4456	75	92	35	1	87 000	162 000	28 000	5 900	3 700
75	NKS75	402	75	95	28	1.1	81 000	123 000	21 900	5 800	3 700

TN=塑料保险架, 允许运转温度: 120°C连续地, 150°C临时地, 180°C短时地。)对于脂润滑, 允许值为表列数值的60%。*有挡圈, 无润滑油孔和槽, 如需要油孔和槽时, 需在轴承代号上增加ASR1。
TN=plastic retainer, permissible operational temperature 120°C, 150°C for temporary use, 180°C for shorttime only *) for grease lub, the permissible value should be 60% of those in the list. with retaining ring, no lubricating holes or grooves, please add ASR1 before the bearing code if oil holes or grooves are needed for your products.

无内圈滚针轴承

Needle Roller Bearings Without Inner Rings

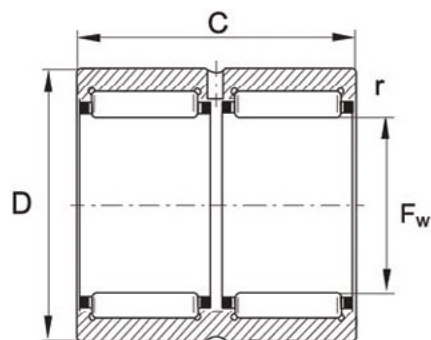

RNA69...-ZW

轴径 Shaft Diameter mm	轴承型号 Bearing Designation	质量 (克) Mass ≈ g	尺寸(毫米) Dimensions (mm)				基本额定负荷 Basic load ratings		极限疲劳 载荷 Fatigue limit load C_{ur} N	极限转速 Limiting speed n_c min ⁻¹	参考转速 Reference speed n_b min ⁻¹
			F_w	D	C	r min.	dyn. C_r 动 N 态	stat. C_{or} 静 N 态			
80	NK80/25	301	80	95	25	1	63 000	119 000	19 600	5 600	3 600
80	NK80/35	425	80	95	35	1	89 000	184 000	32 500	5 600	3 450
80	RNA4914	460	80	100	30	1	95 000	156 000	27 500	5 400	3 200
80	RNA6914-ZW	857	80	100	54	1	145 000	265 000	47 500	5 400	3 250
85	NK85/25	425	85	105	25	1	78 000	123 000	21 700	5 200	3 350
85	NK85/35	600	85	105	35	1	111 000	193 000	34 500	5 200	3 250
85	RNA4915	489	85	105	30	1	97 000	162 000	28 500	5 200	3 050
85	RNA6915-ZW	935	85	105	54	1	147 000	275 000	49 500	5 200	3 050
90	NK90/25	450	90	110	25	1	81 000	132 000	23 300	4 900	3 200
90	NK90/35	630	90	110	35	1	116 000	208 000	37 000	4 900	3 100
90	RNA4916	516	90	110	30	1	101 000	174 000	30 500	4 900	2 850
90	RNA6916-ZW	987	90	110	54	1	153 000	300 000	53 000	4 900	2 850
95	NK95/26	490	95	115	26	1	83 000	137 000	24 000	4 650	3 150
95	NK95/36	680	95	115	36	1	121 000	223 000	39 500	4 650	2 950
100	NK100/26	515	100	120	26	1	86 000	146 000	25 000	4 450	3 000
100	NK100/36	715	100	120	36	1	125 000	237 000	41 500	4 450	2 850
100	RNA4917	657	100	120	35	1.1	125 000	237 000	41 500	4 450	2 650
100	RNA6917-ZW	1 200	100	120	63	1.1	188 000	4000 000	71 000	4 450	2 700
105	NK105/26	540	105	125	26	1	89 000	155 000	26 500	4 250	2 900
105	NK105/36	713	105	125	36	1	129 000	250 000	43 500	4 250	2 750
105	RNA4918	745	105	125	35	1.1	129 000	250 000	43 500	4 250	2 500
105	RNA6918-ZW	1 330	105	125	63	1.1	195 000	425 000	74 000	4 250	2 700
110	NK110/30	650	110	130	30	1.1	111 000	210 000	35 500	4 100	2 700
110	NK110/40	830	110	130	40	1.1	143 000	290 000	50 000	4 100	2 650
110	RNA4919	719	110	130	35	1.1	131 000	260 000	44 500	4 100	2 410
100	RNA6919-ZW	1 460	100	130	63	1.1	197 000	440 000	76 000	4 100	2 450

*TN=塑料保险架, 允许运转温度: 120℃连续地, 150℃临时地, 180℃短时地。¹⁾对于脂润滑, 允许值为表列数值的60%。有挡圈, 无润滑油孔和槽, 如需要油孔和槽时, 需在轴承代号上增加ASR1。
 TN=plastic retainer, permissible operational temperature 120°C, 150°C for temporary use, 180°C for shorttime only ¹⁾ for grease lub, the permissible value should be 60% of those in the list. with retaining ring, no lubricating holes or grooves, please add ASR1 before the bearing code if oil holes or grooves are needed for your products.

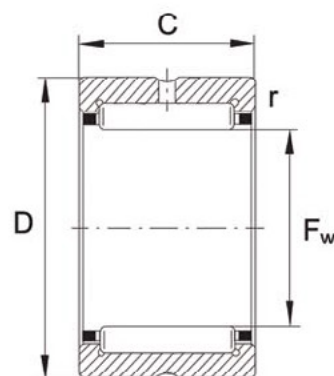

NK, NKS, RNA49, RNA69

轴径 Shaft Diameter mm	轴承型号 Bearing Designation	质量 (克) Mass ≈ g	尺寸(毫米) Dimensions (mm)				基本额定负荷 Basic load ratings		极限疲劳 载荷 Fatigue limit load C _{ur} N	极限转速 Limiting speed n _G min ⁻¹	参考转速 Reference speed n _R min ⁻¹
			F _w	D	C	r min.	dyn. C _r 动 N 态	stat. C _{0r} 静 N 态			
115	RNA4920	1150	115	140	40	1.1	144000	270000	45500	3850	2500
120	RNA4822	670	120	140	30	1	106000	216000	36000	3750	2220
125	RNA4922	1240	125	150	40	1.1	149000	290000	47500	3550	2290
130	RNA4824	730	130	150	30	1	112000	239000	39000	3500	2030
135	RNA4924	1860	135	165	45	1.1	205000	390000	64000	3250	2110
145	RNA4826	990	145	165	35	1.1	134000	310000	48500	3150	1920
150	RNA4926	2210	150	180	50	1.5	229000	470000	74000	2950	1970
155	RNA4828	1 050	155	175	35	1.1	136000	325000	50000	2950	1800
160	RNA4928	2350	160	190	50	1.5	237000	500000	78000	2800	1810
165	RNA4830	1 600	165	190	40	1.1	172 000	400000	62 000	2750	1750
175	RNA4832	1700	175	200	40	1.1	181000	435000	66 000	2600	1630
185	RNA4834	2540	185	215	45	1.1	209000	510000	75000	2450	1550
195	RNA4836	2680	195	225	45	1.1	219000	550000	80000	2330	1430
210	RNA4838	3210	210	240	50	1.5	255000	690 000	100000	2180	1290
220	RNA4840	3350	220	250	50	1.5	260000	720000	102000	2090	1220
240	RNA4844	3620	240	270	50	1.5	275000	790000	110000	1920	1080
265	RNA4848	5400	265	300	60	2	400000	1080000	150000	1730	940
285	RNA4852	5800	285	320	60	2	415000	1160000	158000	1620	860
305	RNA4856	9300	305	350	69	2	510000	1300000	175000	1500	810
330	RNA4860	12700	330	380	80	2.1	700000	1770000	235000	1380	710
350	RNA4864	13400	350	400	80	2.1	710000	1850000	242000	1310	660
370	RNA4868	14000	370	420	80	2.1	730000	1940000	249000	1240	620
390	RNA4872	14800	390	440	80	2.1	740000	2020000	255000	1180	580
415	RNA4876	26000	415	480	100	2.1	1130000	2900000	370000	1090	500

*TN=塑料保险架, 允许运转温度: 120℃连续地, 150℃临时地。180℃短时地。¹⁾ 对于脂润滑, 允许值为表列数值的60%。有挡圈, 无润滑油孔和槽, 如需要油孔和槽时, 需在轴承代号上增加ASR1。
 TN-plastic retainer, permissible operational temperature 120°C, 150°C for temporary use, 180°C for shorttime only¹⁾ for grease lub, the permissible value should be 60% of those in the list, with retaining ring, no lubricating holes or grooves, please add ASR1 before the bearing code if oil holes or grooves are needed for your products.

带内圈滚针轴承

Needle Roller Bearings With Inner Rings

NKI, NKIS,
NA49, NA69, NA48

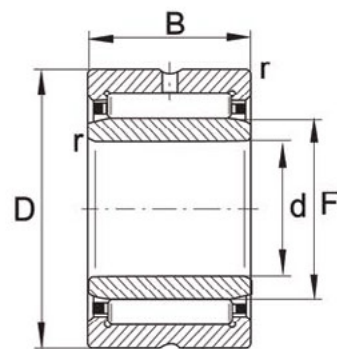

NKI ($d \leq 7 \text{ mm}$)

轴径 Shaft Diameter	轴承型号 Bearing Designation	质量 (克) Mass	尺寸(毫米) Dimensions (mm)						基本额定负荷 Basic load ratings		极限疲劳 载荷 Fatigue limit load C_{ur}	极限转速 Limiting speed n_G	参考转速 Reference speed n_B
			d	F	D	B	r	$s^2)$	dyn. C_r	stat. C_{or}			
mm		≈ g					min.		N	N	N	min ⁻¹	min ⁻¹
5	NKI5/12-TV ¹⁾	11.5	5	8	15	12	0.3	1.5	4 450	4 100	690	31 500	29 500
5	NKI5/16-TV ¹⁾	15.3	5	8	15	16	0.3	2	5 800	5 800	970	31 500	29 500
6	NKI6/12-TV ¹⁾	13.5	6	9	16	12	0.3	1.5	5 100	5 000	840	30 000	26 500
6	NKI6/16-TV ¹⁾	17.4	6	9	16	16	0.3	2	6 600	7 100	1 190	30 000	26 000
7	NKI7/12-TV ¹⁾	13.7	7	10	17	12	0.3	1.5	5 300	5 500	930	29 000	24 100
7	NKI7/16-TV ¹⁾	18.2	7	10	17	16	0.3	2	7 000	7 800	1 310	29 000	23 800
9	NKI9/12	16.6	9	12	19	12	0.3	1.5	7 200	7 100	1 280	26 500	22 200
9	NKI9/16	21.9	9	12	19	16	0.3	2	10 100	11 000	1 920	26 500	19 500
10	NKI10/16	29.4	10	14	22	16	0.3	0.5	11 400	11 500	2 100	25 000	17 300
10	NKI10/20	37.1	10	14	22	20	0.3	0.5	14 500	15 600	2 700	25 000	17 000
10	NA4900	23	10	14	22	13	0.3	0.5	9 600	9 200	1 630	25 000	17 300
12	NKI12/16	33.3	12	16	24	16	0.3	0.5	12 800	13 900	2 550	23 600	15 200
12	NKI12/20	41.9	12	16	24	20	0.3	0.5	16 300	18 800	3 250	23 600	14 900
12	NA4901	26	12	16	24	13	0.3	0.5	10 600	10 900	1 940	23 600	14 900
12	NA6901	46	12	16	24	22	0.3	1	18 100	21 600	3 800	23 600	13 900
15	NKI15/16	38.8	15	19	27	16	0.3	0.5	14 700	17 400	3 200	21 800	12 800
15	NKI15/20	48.7	15	19	27	20	0.3	0.5	18 700	23 600	4 150	21 800	12 600
15	NA4902	34	15	20	28	13	0.3	0.5	12 000	13 600	2 430	21 600	12 000
15	NA6902	63.6	15	20	28	23	0.3	1	19 500	25 500	4 450	21 600	11 700
15	NKIS15	92	15	22	35	20	0.6	0.5	27 500	28 000	4 900	19 600	10 300
17	NKI17/16	42.4	17	21	29	16	0.3	0.5	15 200	18 700	3 450	20 900	11 800
17	NKI17/20	53.4	17	21	29	20	0.3	0.5	19 300	25 500	4 450	20 900	11 600
17	NA4903	37	17	22	30	13	0.3	0.5	12 400	14 600	2 600	20 600	10 900
17	NA6903	72	17	22	30	23	0.3	1	21 100	29 000	5 100	20 600	10 500
17	NKIS17	98	17	24	37	20	0.6	0.5	29 500	31 000	5 400	18 100	9 500

¹⁾ With closing rings, without lubrication hole and groove. 双挡圈, 无润滑油孔和油槽。

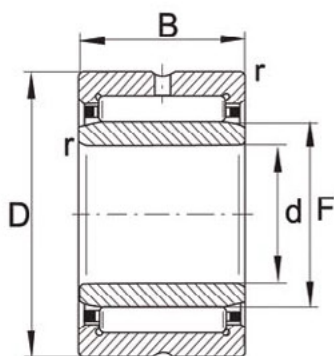

NKI ($d \geq 9$ mm), NKIS, NA49, NA69 ($d \leq 30$ mm)

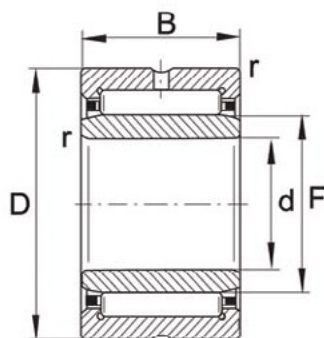

NKI, NKIS, NA49, NA69 ($d \leq 30$ mm)

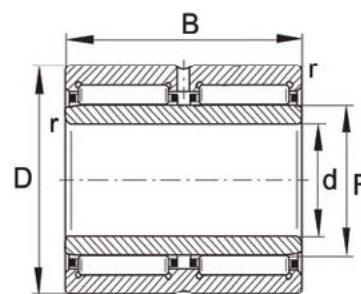

NA69..-ZW

轴径 Shaft Diameter mm	轴承型号 Bearing Designation	质量 (克) Mass ≈ g	尺寸(毫米) Dimensions (mm)						基本额定负荷 Basic load ratings		极限疲劳 载荷 Fatigue limit load C_{ur} N	极限转速 Limiting speed n_G min ⁻¹	参考转速 Reference speed n_B min ⁻¹
			d	F	D	B	r	s ²⁾	dyn. C_r 动态 N	stat. C_{or} 静态 N			
20	NKI20/16	49	20	24	32	16	0.3	0.5	16 900	22 300	4 100	18 800	10 400
20	NKI20/20	61	20	24	32	20	0.3	0.5	21 400	30 500	5 300	18 800	10 200
20	NA4904	75.2	20	25	37	17	0.3	0.8	23 700	25 500	4 600	17 200	9 600
20	NA6904	141	20	25	37	30	0.3	1	40 500	51 000	9 100	17 200	9 200
20	NKIS20	129	20	28	42	20	0.6	0.5	32 500	36 500	6 400	15 800	8 300
22	NKI22/16	52	22	26	34	16	0.3	0.5	17 300	23 600	4 350	17 500	9 800
22	NKI22/20	65.4	22	26	34	20	0.3	0.5	22 000	32 000	5 600	17 500	9 500
22	NA49/22	80	22	28	39	17	0.3	0.8	26 000	29 500	5 300	16 100	8 700
22	NA69/22	150	22	28	39	30	0.3	0.5	42 000	55 000	9 900	16 100	8 500
25	NKI25/20	75.8	25	29	38	20	0.3	1	17 500	39 000	6 800	15 600	8 300
25	NKI25/30	124	25	29	38	30	0.3	1.5	37 000	57 000	10 600	15 600	8 400
25	NA4905	88	25	30	42	17	0.3	0.8	26 500	31 500	5 700	14 600	7 900
25	NA6905	161	25	30	42	30	0.3	1	44 000	59 000	10 600	14 600	7 700
25	NKIS25	162	25	32	47	22	0.6	1	38 000	43 500	7 400	13 600	7 400
28	NKI28/20	92.4	28	32	42	20	0.3	1	29 500	44 500	7 800	14 000	7 500
28	NKI28/30	146	28	32	42	30	0.3	1.5	39 000	63 000	11 700	14 000	7 600
28	NA49/28	97.7	28	32	45	17	0.3	0.8	27 500	33 500	6 100	13 400	7 200
28	NA69/28	182	28	32	45	30	0.3	1	45 500	636 000	11 400	13 400	7 000
30	NKI30/20	108	30	35	45	20	0.3	0.5	31 000	48 500	8 500	13 100	7 000
30	NKI30/30	165	30	35	45	30	0.3	1	46 000	81 000	15 000	13 100	6 700
30	NA4906	101	30	35	47	17	0.3	0.8	28 500	35 500	6 400	12 700	6 800
30	NA6906	192	30	35	47	30	0.3	1	49 000	71 000	12 900	12 700	6 400
30	NKIS30	184	30	37	52	22	0.6	1	41 500	50 000	8 600	12 000	6 600
32	NKI32/20	118	32	37	47	20	0.3	0.5	28 000	43 500	7 600	12 400	7 000
32	NKI32/30	180	32	37	47	30	0.3	1	42 000	73 000	13 500	12 400	6 800
32	NA49/32	158	32	40	52	20	0.6	0.8	34 500	47 500	8 900	11 700	6 500
32	NA69/32-ZW	288	32	40	52	36	0.6	0.5	53 000	82 000	15 100	11 700	6 500
35	NKI35/20	122	35	40	50	20	0.3	0.5	33 500	56 000	9 800	11 500	6 200
35	NKI35/30	193	35	40	50	30	0.3	1	44 000	79 000	14 600	11 500	6 300
35	NA4907	170	35	42	55	20	0.6	0.8	35 500	50 000	9 400	10 900	6 000
35	NA6907-ZW	310	35	42	55	36	0.6	0.5	54 000	86 000	15 900	10 900	6 100
35	NKIS35	220	35	43	58	22	0.6	0.5	44 000	57 000	9 800	10 500	5 900

带内圈滚针轴承

Needle Roller Bearings With Inner Rings

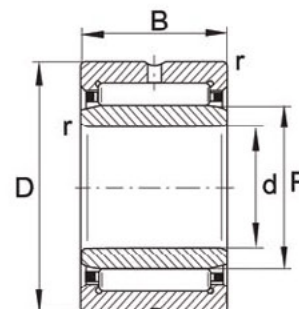

NKI, NKIS, NA49

轴径 Shaft Diameter	轴承型号 Bearing Designation	质量 (克) Mass	尺寸(毫米) Dimensions (mm)						基本额定负荷 Basic load ratings		极限疲劳 载荷 Fatigue limit load C_{ur} N	极限转速 Limiting speed n_G min ⁻¹	参考转速 Reference speed n_B min ⁻¹
			d	F	D	B	r	s ¹⁾	dyn. C_r N	stat. C_{or} N			
mm		≈ g					min.		动态	静态			
38	NKI38/20	136	38	43	53	20	0.3	0.5	30 500	51 000	8 900	10 800	6 200
38	NKI38/30	207	38	43	53	30	0.3	1	45 500	85 000	15 800	10 800	6 000
40	NKI40/20	136	40	45	55	20	0.3	0.5	35 000	62 000	10 800	10 300	5 600
40	NKI40/30	216	40	45	55	30	0.3	1	52 000	103 000	19 100	10 300	5 500
40	NA4908	230	40	48	62	22	0.6	1	48 500	67 000	11 500	9 600	5 300
40	NA6908-ZW	430	40	48	62	40	0.6	0.5	74 000	116 000	19 400	9 600	5 400
40	NKIS40	281	40	50	65	22	1	0.5	48 000	67 000	11 500	9 300	5 200
42	NKI42/20	148	42	47	57	20	0.3	0.5	32 500	56 000	9 900	9 900	5 700
42	NKI42/30	222	42	47	57	30	0.3	1	48 500	94 000	17 500	9 900	5 500
45	NKI45/25	217	45	50	62	25	0.6	1.5	48 500	87 000	14 800	9 200	5 100
45	NKI45/35	308	45	50	62	35	0.6	2	67 000	132 000	23 900	9 200	4 950
45	NA4909	271	45	52	68	22	0.6	1	51 000	73 000	12 600	8 700	4 750
45	NA6909-ZW	495	45	52	68	40	0.6	0.5	79 000	127 000	21 400	8 700	4 850
45	NKIS45	336	45	55	72	22	1	0.5	51 000	74 000	12 700	8 400	4 750
50	NKI50/25	270	50	55	68	25	0.6	1.5	45 500	82 000	14 000	8 300	4 900
50	NKI50/35	379	50	55	68	35	0.6	2	60 000	118 000	21 300	8 300	4 850
50	NA4910	274	50	58	72	22	0.6	1	53 000	80 000	13 800	8 000	4 350
50	NA6910-ZW	515	50	58	72	40	0.6	0.5	82 000	139 000	23 400	8 000	4 400
50	NKIS50	518	50	60	80	28	1.1	2	71 000	98 000	17 300	7 500	4 450
55	NKI55/25	255	55	60	72	25	0.6	1.5	47 500	90 000	15 400	7 700	4 600
55	NKI55/35	379	55	60	72	35	0.6	2	63 000	130 000	23 500	7 700	4 500
55	NA4911	393	55	63	80	25	1	1.5	65 000	100 000	17 300	7 300	4 100
55	NA6911-ZW	780	55	63	80	45	1	1.5	102 000	176 000	30 000	7 300	4 100
55	NKIS55	558	55	65	85	28	1.1	2	75 000	108 000	22 200	7 000	4 150
60	NKI60/25	394	60	68	82	25	0.6	1	49 500	89 000	15 200	6 900	4 300
60	NKI60/35	553	60	68	82	35	0.6	1	70 000	139 000	25 500	6 900	4 150
60	NA4912	426	60	68	85	25	1	1.5	68 000	108 000	18 800	6 800	3 750
60	NA6912-ZW	808	60	68	85	45	1	1.5	106 000	191 000	32 500	6 800	3 750
60	NKIS60	560	60	70	90	28	1.1	2	77 000	113 000	23 400	6 500	3 950

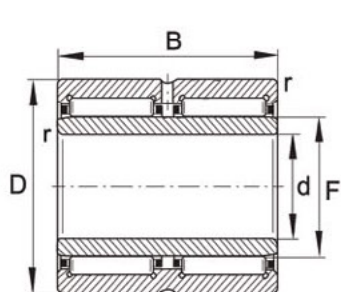

NA69...-ZW

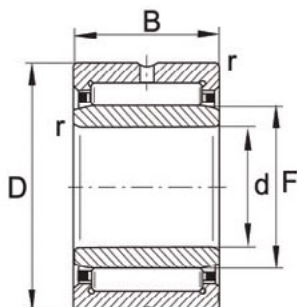

NKI, NKIS, NA49

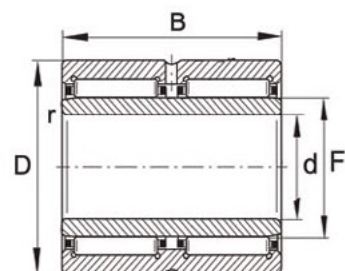

NA69...-ZW

轴径 Shaft Diameter mm	轴承型号 Bearing Designation	质量 (克) Mass ≈ g	尺寸(毫米) Dimensions (mm)						基本额定负荷 Basic load ratings		极限疲劳 载荷 Fatigue limit load C _{ur} N	极限转速 Limiting speed n _G min ⁻¹	参考转速 Reference speed n _B min ⁻¹
			d	F	D	B	r	s ¹⁾	dyn. C _r 动态 N	stat. C _{or} 静态 N			
65	NKI65/25	467	65	73	90	25	1	1	60 000	100 000	17 500	6 300	3 950
65	NKI65/35	659	65	73	90	35	1	1	85 000	156 000	27 000	6 300	3 800
65	NA4913	456	65	72	90	25	1	1.5	69 000	112 000	19 500	6 300	3 500
65	NA6913-ZW	833	65	72	90	45	1	1.5	108 000	198 000	33 500	6 300	3 550
65	NKIS65	641	65	75	95	28	1.1	2	81 000	123 000	25 500	6 100	3 700
70	NKI70/25	521	70	80	95	25	1	0.8	63 000	119 000	19 600	5 900	3 600
70	NKI70/35	737	70	80	95	35	1	0.8	89 000	184 000	32 500	5 900	3 500
70	NA4914	728	70	80	100	30	1	1.5	95 000	156 000	27 500	5 800	3 350
70	NA6914-ZW	1 340	70	80	100	54	1	1	145 000	265 000	47 500	5 800	3 400
75	NKI75/25	641	75	85	105	25	1	1	78 000	123 000	23 500	5 400	3 400
75	NKI75/35	908	75	85	105	35	1	1	111 000	193 000	40 000	5 400	3 250
75	NA4915	775	75	85	105	30	1	1.5	97 000	162 000	28 500	5 400	3 150
75	NA6915-ZW	1 450	75	85	105	54	1	1	147 000	275 000	49 500	5 400	3 200
80	NKI80/25	677	80	90	110	25	1	1	81 000	132 000	27 500	5 200	3 250
80	NKI80/35	959	80	90	110	35	1	1	116 000	208 000	43 000	5 200	3 100
80	NA4916	878	80	90	110	30	1	1.5	101 000	174 000	30 500	5 200	2 950
80	NA6916-ZW	1 522	80	90	110	54	1	1	153 000	300 000	53 000	5 200	3 000
85	NKI85/26	743	85	95	115	26	1	1.5	83 000	137 000	28 000	4 900	3 150
85	NKI85/36	1 040	85	95	115	36	1	1.5	121 000	223 000	46 000	4 900	3 000
85	NA4917	1 250	85	100	120	35	1.1	1	125 000	237 000	41 500	4 800	2 800
85	NA6917-ZW	2 200	85	100	120	63	1.1	1	188 000	400 000	71 000	4 800	2 850
90	NKI90/26	778	90	100	120	26	1	1.5	86 000	146 000	29 500	4 650	3 050
90	NKI90/36	1 090	90	100	120	36	1	1.5	125 000	237 000	48 000	4 650	2 850
90	NA4918	1 312	90	105	125	35	1.1	1	129 000	250 000	43 500	4 550	2 650
90	NA6918-ZW	2 310	90	105	125	63	1.1	1	195 000	425 000	74 000	4 550	2 700
95	NKI95/26	816	95	105	125	26	1	1.5	89 000	155 000	31 000	4 450	2 900
95	NKI95/36	1 145	95	105	125	36	1	1.5	129 000	250 000	50 000	4 450	2 750
95	NA4919	1 371	95	110	130	35	1.1	1	131 000	260 000	44 500	4 350	2 550
95	NA6919-ZW	2 500	95	110	130	63	1.1	1	197 000	440 000	76 000	4 530	2 600

推力圆柱滚子轴承

Axial Cylindrical Roller Bearings

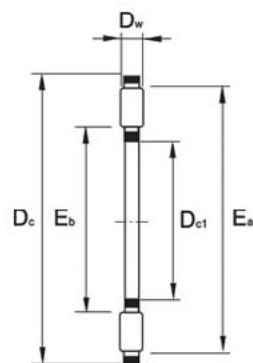

AXK

轴径 Shaft Diameter mm	推力滚针和 保持架组件 Thrust needle & retainer assembly	尺寸 Dimensions					滚道尺寸 Roll path size		基本额定负荷 Basic Load Rating		极限转速 Limiting Speed $n^{100000} \approx \text{min}^{-1}$
		D_{c1} d	D_c D	d_i	D_w	B_1	E_b	E_a	动 C_r Dynamic	静 C_{or} Static	
4	AXK0414TN	4	14	--	2	1	5	13	4450	8000	18000
5	AXK0515TN	5	15	--	2	1	6	14	4750	9200	17000
6	AXK0619TN	6	19	--	2	1	7	18	6800	15500	16000
8	AXK0821TN	8	21	--	2	1	9	20	7800	19400	15000
10	AXK1024	10	24	--	2	1	12	23	9200	25500	14000
12	AXK1226	12	26	--	2	1	14	25	9900	29000	13000
15	AXK1528	15	28	28	2	1	17	27	11300	36000	11000
17	AXK1730	17	30	30	2	1	19	29	11900	39500	10000
20	AXK2035	20	35	35	2	1	22	34	13100	46500	8500
25	AXK2542	25	42	42	2	1	29	41	14700	58000	7000
30	AXK3047	30	47	47	2	1	34	46	16300	70000	6000
35	AXK3552	35	52	52	2	1	39	51	17800	81000	5500
40	AXK4060	40	60	60	3	1	45	58	28000	114000	4700
45	AXK4565	45	65	65	3	1	50	63	30000	128000	4300
50	AXK5070	50	70	70	3	1	55	68	32000	143000	3900
55	AXK5578	55	78	78	3	1	60	76	38000	186000	3500
60	AXK6085	60	85	85	3	1	65	83	44500	234000	3200
65	AXK6590	65	90	90	3	1	70	88	46500	255000	3000
70	AXK7095	70	95	95	4	1	74	93	54000	255000	2900
75	AXK75100	75	100	100	4	1	79	98	55000	265000	2700
80	AXK80105	80	105	105	4	1	84	103	56000	280000	2600
85	AXK85110	85	110	110	4	1	89	108	58000	290000	2400
90	AXK90120	90	120	120	4	1	94	118	73000	405000	2300
100	AXK100135	100	135	135	4	1	105	133	91000	560000	2000
110	AXK110145	110	145	145	4	1	115	143	97000	620000	1900
120	AXK120155	120	155	155	4	1	125	153	102000	680000	1700
130	AXK130170	130	170	170	5	1	136	167	133000	840000	1600
140	AXK140180	140	180	178	5	1	146	177	138000	900000	1500
150	AXK150190	150	190	188	5	1	156	187	143000	960000	1400
160	AXK160200	160	200	198	5	1	166	197	148000	1020000	1300

推力轴承垫圈

Axial Bearing Washers

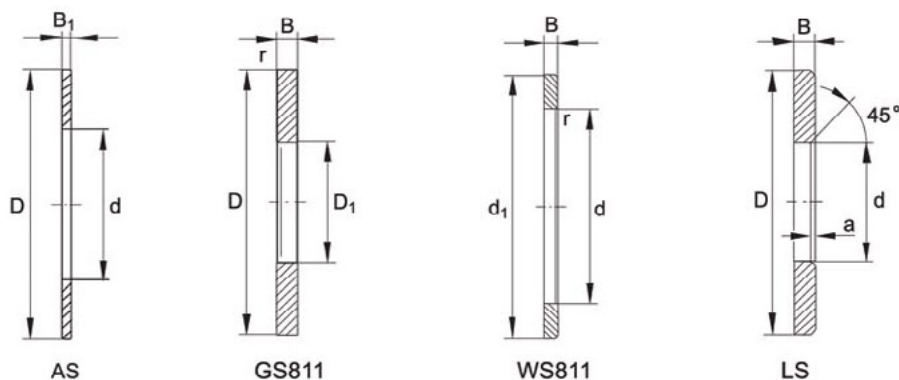

轴径 Shaft Diameter	轴承型号与近似重量 Bearing Designation and mass approx							外形尺寸 Boundary Dimensions					
	垫圈 Bearing Washer	重量 Mass g	定位座圈 Housing Locating washer	重量 Mass g	定位轴承 Shaft Locating washer	垫圈 Bearing Washer	重量 Mass g	d ₁	D ₁	D	d ₁	B ₁ ^{注1}	B
								mm					
4	AS 0414	1	-	-	-	-	-	4	-	14	-	1	-
5	AS 0515	1	-	-	-	-	-	5	-	15	-	1	-
6	AS 0619	2	-	-	-	LS 0619	4	6	-	19	-	1	2.75
8	AS 0821	2	-	-	-	LS 0821	4	8	-	21	-	1	2.75
10	AS 1024	3	-	-	-	LS 1024	7	10	-	24	-	1	2.75
12	AS 1226	3	-	-	-	LS 1226	8	12	-	26	-	1	2.75
15	AS 1528	3	GS 81102	8	WS 81102	LS 1528	9	15	16	28	28	1	2.75
17	AS 1730	4	GS 81103	9	WS 81103	LS 1730	9	17	18	33	30	1	2.75
20	AS 2035	5	GS 81104	12	WS 81104	LS 2035	13	20	21	35	35	1	2.75
25	AS 2542	7	GS 81105	19	WS 81105	LS 2542	19	25	26	42	40	1	3
30	AS 3047	8	GS 81106	20	WS 81106	LS 3047	22	30	32	47	47	1	3
35	AS 3552	9	GS 81107	27	WS 81107	LS 3552	29	35	37	52	52	1	3.5
40	AS 4060	12	GS 81108	37	WS 81108	LS 4060	40	40	42	60	60	1	3.5
45	AS 4565	13	GS 81109	47	WS 81109	LS 4565	50	45	47	65	65	1	4
50	AS 5070	14	GS 81110	51	WS 81110	LS 5070	55	50	52	70	70	1	4
55	AS 5578	18	GS 81111	82	WS 81111	LS 5578	88	55	57	78	78	1	5
60	AS 6085	22	GS 81112	92	WS 81112	LS 6085	97	60	62	85	85	1	4.75
65	AS 6590	24	GS 81113	110	WS 81113	LS 6590	115	65	67	90	90	1	5.25
70	AS 7095	25	GS 81114	120	WS 81114	LS 7095	123	70	72	95	95	1	5.25
75	AS 75100	27	GS 81115	136	WS 81115	LS 75100	142	75	77	100	100	1	5.75
80	AS 80105	28	GS 81116	144	WS 81116	LS 80105	151	80	82	105	105	1	5.75
85	AS 85110	29	GS 81117	151	WS 81117	LS 85110	159	85	87	110	110	1	5.75
90	AS 90120	39	GS 81118	225	WS 81118	LS 90120	234	90	92	120	120	1	6.5
100	AS 100135	50	GS 81120	350	WS 81120	LS 100135	350	100	102	135	135	1	7
110	AS 110145	55	GS 81122	385	WS 81122	LS 110145	385	110	112	145	145	1	7
120	AS 120155	59	GS 81124	415	WS 81124	LS 120155	415	120	122	155	155	1	7
130	AS 130170	65	GS 81126	642	WS 81126	LS 130170	663	130	132	170	170	1	9
140	AS 140180	79	GS 81128	749	WS 81128	LS 140180	749	140	142	180	178	1	9.5
150	AS 150190	84	GS 81130	796	WS 81130	LS 150190	796	150	152	190	188	1	9.5
160	AS 160200	89	GS 81132	842	WS 81132	LS 160200	842	160	162	200	198	1	9.5

冲压外圈滚针轴承

Drawn Cup Needle Roller Bearing

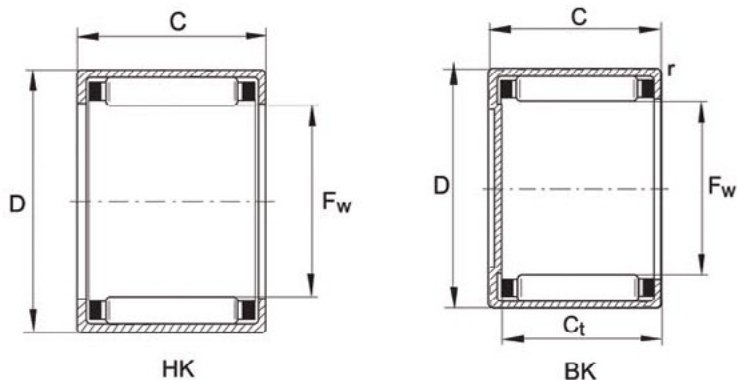

型号 Bearing number		外形尺寸 Dimensions Fw × D × C	型号 Bearing number		外形尺寸 Dimensions Fw × D × C	型号 Bearing number		外形尺寸 Dimensions Fw × D × C
穿孔型 Open end	封口型 Closed end		穿孔型 Open end	封口型 Closed end		穿孔型 Open end	封口型 Closed end	
HK0306TN	BK0306TN	3x6.5x6	HK1210	BK1210	12x16x10	HK17x21.5x15	-	17x21.5x15
HK0408TN	BK0408TN	4x8x8	HK121 2	BK1212	12x16x12	HK1712	BK1712	17x23x12
HK0508	BK0508	5x9x8	HK12x17x12	-	12x17x12	HK1714	-	17x23x14
HK0509	BK0509	5x9xg	HK12x17x15	-	12x17x15	HK1716	-	17x23x16
HK0511	-	5x9x11	HK12x17x18	-	12x17x18	HK1718	-	17x23x18
HK0607	-	6x10x7	HK12x18x12	BK12x18x12	12x18x12	HK17x24x15	-	17x24x15
HK0608	BK0608	6x10x8	HK12x18x14	-	12x18x14	HK17x25x14	-	17x25x14
HK0609	BK0609	6x10x9	HK12x18x20	-	12x18x20	HK17x25x15.5	-	17x25x15.5
HK0611	-	6x10x11	HK12x19x12	-	12x19x12	HK17x25x18	-	17x25x18
HK06x12x08	-	6x12x8	HK1311	-	13x19x11	HK1812	BK1812	18x24x12
HK0708	-	7x11x8	HK1312	BK1312	13x19x12	HK1816	BK1816	18x24x16
HK0709	BK0709	7x11x9	HK13.5x20x12	-	13.5x20x12	HK18x25x25	-	18x25x25
HK07x12x08	-	7x12x8	HK1410	BK1412	14x20x10	HK19x27x16	-	19x27x16
HK07x12x09	-	7x12x9	HK1412	-	14x20x12	HK2010	BK2010	20x26x10
HK0808	BK0808	8x12x8	HK1414	-	14x20x14	HK2011	-	20x26x11
HK0810	BK0810	8x12x10	HK1416	-	14x20x16	HK2012	BK2012	20x26x12
HK0812	-	8x12x12	HK1420	-	14x20x20	HK2014	-	20x26x14
HK08x14x10	BK08x14x10	8x14x10	HK15x20x12	-	15x20x12	HK2016	BK2016	20x26x16
HK08x14x12	-	8x14x12	HK15x20x16	-	15x20x16	HK2018	-	20x26x18
HK08x15x10	-	8x15x10	HK15x20x20	-	15x20x20	HK2020	BK2020	20x26x20
HK0908	BK0908	9x13x8	HK1512	BK1512	15x21x12	HK20x27x25	-	20x27x25
HK0910	BK0910	9x13x10	HK1514	-	15x21x14	HK2025	-	20x26x25
HK0911	-	9x13x11	HK1515	-	15x21x15	HK2030	BK2030	20x26x30
HK0912	BK0912	9x13x12	HK1516	BK1516	15x21x16	HK202718	-	20x27x18
HK09x14x25	-	9x14x12.5	HK1520	-	15x21x20	HK202720	-	20x27x20
HK09x15x10	-	9x15x10	HK1522	BK1522	15x21x22	H K202730	-	20x27x30
HK10x13x08	-	10x13x8	HK15x22x12	-	15x22x12	HK202816	-	20x28x16
HK1010	BK1010	10x14x10	HK15x22x12.5	-	15x22x12.5	HK202918	-	20x29x18
HK1012	BK1012	10x14x12	HK16x21x06	-	16x21x6	HK22287.5TN	-	22x28x7.5
HK1015	BK1015	10x14x15	HK16x21x09	-	16x21x9	HK2210	-	22x28x10
HK10x15x15	-	10x15x15	HK1610	-	16x22x10	HK2212	BK2212	22x28x12
HK10x16x10	BK10x16x10	10x16x10	HK1612	BK1612	16x22x12	HK2216	BK2216	22x28x16
HK10x16x12	-	10x16x12	HK1614	-	16x22x14	HK2220	BK2220	22x28x20
HK10x16x15	-	10x16x15	HK1616	BK1616	16x22x16	HK2230	-	22x28x30
HK10x17x10	-	10x17x10	HK1617	-	16x22x17	HK222925	-	22x29x25
HK10x17x15	-	10x17x15	HK1618	-	16x22x18	HK222930	-	22x29x30
HK10x18x12	-	10x18x12	HK1620	-	16x22x20	HK223014	-	22x30x14
HK1208	-	12x16x8	HK1622	BK1622	16x22x22	HK24307.5	-	24x30x7.5

冲压外圈滚针轴承

Drawn Cup Needle Roller Bearing

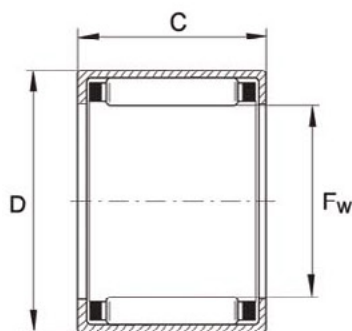

HK

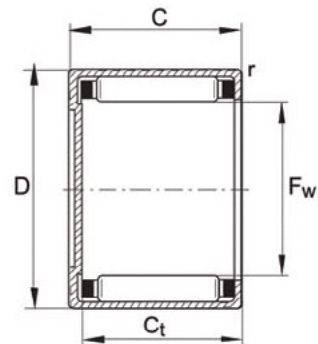

BK

型号 Bearing number		外形尺寸 Dimensions Fw x D x C	型号 Bearing number		外形尺寸 Dimensions Fw x D x C	型号 Bearing number		外形尺寸 Dimensions Fw x D x C
穿孔型 Open end	封口型 Closed end		穿孔型 Open end	封口型 Closed end		穿孔型 Open end	封口型 Closed end	
HK2512	BK2512	25x32x12	HK303812	-	30x38x12	HK405032	-	40x5032
HK2514	-	25x32x14	HK303816	-	30x38x16	HK405038	-	40x50x38
HK2516	BK2516	25x32x16	HK303824	-	30x38x24	HK4512	BK4512	45x52x12
HK2518	-	25x32x18	HK303832	-	30x38x32	HK4516	-	45x52x16
HK2520	BK2520	25x32x20	HK323811	-	32x38x11	HK4520	BK4516	45x52x20
HK2525	-	25x32x25	HK3224	-	32x39x24	HK455538	BK4520	45x55x38
HK2526	BK2526	25x32x26	HK3232	-	32x39x32	HK50571 6	-	50x57x16
HK2538	BK2538	25x32x38	HK324032	-	32x40x32	HK5012	-	5Dx58x12
HK253310	-	25x33x10	HK3512	BK3512	35x42x12	HK5016	-	50x58x16
HK253315	-	25x33x15	HK3516	BK3516	35x42x16	HK5018	-	50x58x18
HK253520	-	25x35x20	HK3520	BK3520	35x42x20	HK5020	BK5020	50x58x20
HK2816	BK2816	28x35x16	HK354316	-	35x43x16	HK5025	BK5025	50x58x25
HK2818	-	28x35x18	HK354325	-	35x43x25	HK506038	-	50x60x38
HK2820	BK2820	28x35x20	HK354332	-	35x43x32	HK5520	BK5520	55x63x20
HK3012	BK3012	30x37x12	HK354512	-	35x45x12	HK5525	-	55x63x25
HK3016	BK3016	30x37x16	HK364212	-	36x42x12	HK5528	BK5528	55x63x28
HK3018	-	30x37x18	HK384830	-	38x48x30	HK6012	BK6012	60x68x12
HK3020	BK3020	30x37x20	HK4012	BK4012	40x47x12	HK6020	BK6020	60x68x20
HK3026	BK3026	30x37x26	HK4016	BK4016	40x47x16	HK6032	BK6032	60x68x32
HK3038	BK3038	30x37x38	HK4020	BK4020	40x47x20			

冲压外圈滚针离合器

Drawn Cup Roller Clutch

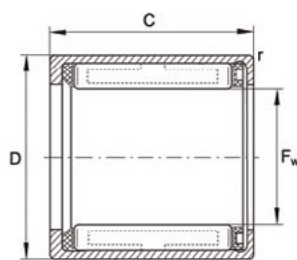

HF RC..FS

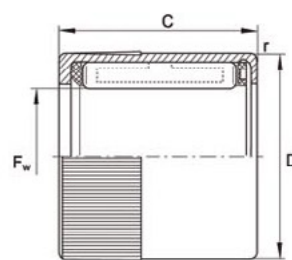

HF RC..FS

型号 Bearing number		外形尺寸 Dimensions F _w × D × C	型号 Bearing number		外形尺寸 Dimensions F _w × D × C
	HF0306KF	3x6.5x6		RC02	3.18x7.14x6.35
	HF0406KF	4x8x6		RC040708	6.35x11.11x12.7
HF0612	HF0612KF	6x10x12	RC061008FS	RC061008	9.52x15.88x12.7
HF0812	HF0812KF	8x12x12	RC081208FS	RC081208	12.7x19.05x12.7
HF1012	HF1012KF	10x14x12	RC101410FS	RC101410	15.88x22.22x15.88
HF1216		12x18x16	RC121610FS	RC121610	19.05x25.4x15.88
HF1416		14x20x16	RC1612110FS	RC162110	25.4x33.34x15.88
HF1616		16x22x16			
HF1816		18x24x16			
HF2016		20x26x16			
HF2520		25x32x20			
HF3020		30x37x20			
HF3520		35x42x20			

冲压外圈滚针离合器和轴承组件

Drawn Cup Roller Clutch and Bearing Assemblies

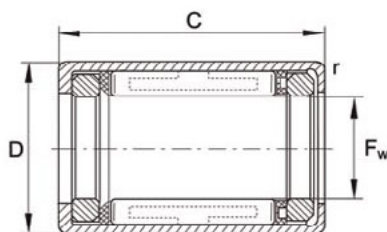

HFL RCB..FS

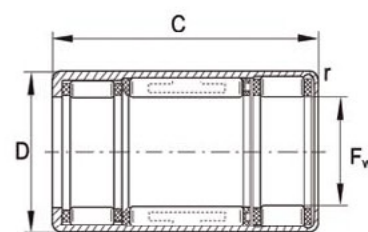

HFL RCB..FS

型号 Bearing number		外形尺寸 Dimensions F _w × D × C	型号 Bearing number		外形尺寸 Dimensions F _w × D × C
	HFL0308KF	3x6.5x8	RCB061014FS	RCB061014	9.52x15.88x22.22
	HFL0408KF	4x8x8	RCB081214FS	RCB081214	12.7x19.05x22.22
HFL0615	HFL0615KF	6x10x15	RCB101416FS	RCB101416	15.88x22.22x25.4
HFL0822	HFL0822KF	8x12x22	RCB121616FS	RCB121616	19.05x25.4x25.4
HFL1022		10x14x22	RCB162117FS	RCB162117	25.4x33.34x27
HFL1226		12x18x26			
HFL1426		14x20x26			
HFL1626		16x22x26			
HFL1826		18x24x26			
HFL2026		20x26x26			
HFL2530		25x32x30			
HFL3030		30x37x30			
HFL3530		35x42x30			

向心滚针和保持架组件

Radial Needle Roller and Cage Assemblies

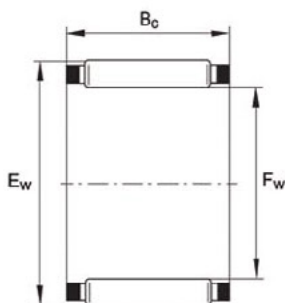

K

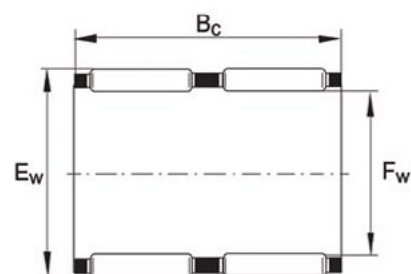

K...-ZW





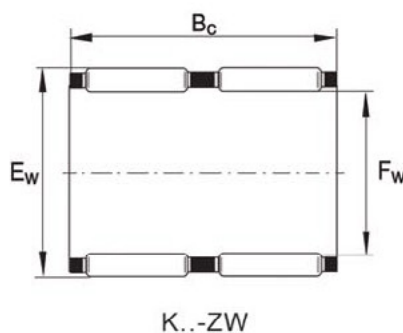
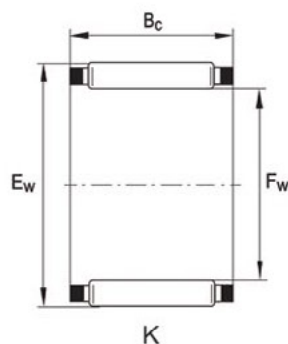

型号 Bearing number	外形尺寸 Dimensions Fw x Ew x Bc	型号 Bearing number	外形尺寸 Dimensions Fw x Ew x Bc	型号 Bearing number	外形尺寸 Dimensions Fw x Ew x Bc	型号 Bearing number	外形尺寸 Dimensions Fw x Ew x Bc	型号 Bearing number	外形尺寸 Dimensions Fw x Ew x Bc	型号 Bearing number	外形尺寸 Dimensions Fw x Ew x Bc
K5X8X8 TN		K14X20X12		K18X28X16		K25X29X10		K30X35X13		K35X45X49	
K5X8X10 TN		K15X18X14		K19X23X13		K25X29X13		K30X35X17		K35X40X30	
K6X9X8 TN		K15X18X17 TN		K19X23X17		K25X29X17		K30X35X27		K35X42X20	
K6X9X10 TN		K15X19X10		K20X24X10		K25X30X13		K30X37X16		K36X41X30	
K6X10X13 TN		K15X19X13		K20X24X12		K25X30X20		K30X37X18		K36X42X16	
K7X10X8 TN		K15X19X17		K20X24X13		K25X30X25		K30X38X25		K37X42X17	
K7X10X10 TN		K15X19X24		K20X24X17		K25X30X26		K30X40X18		K37X42X27	
K8X11X8 TN		K15X20X13		K20X26X12		K25X31X17		K30X40X30		K37X45X26	
K8X11X10 TN		K15X21X12		K20X26X13		K25X31X21		K30X35X26		K38X43X17	
K8X11X13 TN		K15X21X15		K20X26X14		K25X32X16		K32X37X13		K38X43X27	
K8X12X10 TN		K15X21X21		K20X26X16		K25X33X20		K32X37X17		K38X46X20	
K9X12X10 TN		K16X20X10		K20X26X17		K25X33X24		K32X37X27		K38X46X32	
K9X12X13 TN		K16X20X13		K20X26X20		K25X34X18		K32X37X28 TN		K39X44X24	
K10X13X10 TN		K16X20X23.8		K20X28X20		K25X35X30		K32X38X16		K39X44X26	
K10X13X13 TN		K16X21X10		K20X28X25		K25X30X26		K32X38X20		K40X44X13	
K10X13X16 TN		K16X22X12		K20X30X30		K26X30X10		K32X38X26 TN		K40X45X13	
K10X14X10 TN		K16X22X13		K21X25X13		K26X30X13		K32X39X16		K40X45X17	
K10X14X13 TN		K16X22X16		K21X25X17		K26X30X17		K32X39X18		K40X45X21	
K10X16X12 TN		K16X22X20		K22X26X10		K26X31X13		K32X40X20		K40X45X27	
K12X15X9 TN		K16X23X14		K22X26X13		K26X30X22		K32X40X25		K40X46X17	
K12X15X10 TN		K16X24X20		K22X26X17		K26X32X27		K32X40X36		K40X47X18	
K12X15X13 TN		K17X21X10		K22X27X13		K28X32X16.5		K32X46X32		K40X47X20	
K12X15X20 TN		K17X21X13		K22X28X17		K28X32X17		K32X40X42 TN		K40X48X20	
K12X16X8 TN		K17X21X17		K22X28X23		K28X33X13		K35X40X13		K40X45X30	
K12X16X10 TN		K17X23X14		K22X29X16		K28X33X17		K35X40X17		K42X47X13	
K12X16X13 TN		K18X22X10		K22X30X15 TN		K28X33X27 TN		K35X40X25		K42X47X17	
K12X17X13 TN		K18X22X13		K22X30X20		K28X34X17		K35X40X27 TN		K42X47X25 TN	
K12X18X12 TN		K18X22X17		K22X32X24		K28X35X16		K35X40X27		K42X47X27	
K14X17X10		K18X24X12		K23X35X16 TN		K28X35X18		K35X40X30		K42X48X35	
K14X17X17		K18X24X13		K24X28X10		K28X35X20		K35X42X16		K42X50X18	
K14X18X10		K18X24X13.5		K24X28X13		K28X35X27		K35X42X18		K42X50X20	
K14X18X13		K18X24X20		K24X28X17		K28X36X16		K35X42X30		K42X47X30	
K14X18X14		K18X25X14		K24X29X13		K28X40X18		K35X43X18		K43X48X17	
K14X18X15		K18X25X22		K24X30X17		K28X40X25		K35X45X20		K43X48X27	
K14X18X17		K18X26X14		K24X30X31		K30X34X13		K35X45X30		K43X50X18	

向心滚针和保持架组件

Radial Needle Roller and Cage Assemblies



型号 Bearing number	外形尺寸 Dimensions F _w × E _w × B _c	型号 Bearing number	外形尺寸 Dimensions F _w × E _w × B _c	型号 Bearing number	外形尺寸 Dimensions F _w × E _w × B _c	型号 Bearing number	外形尺寸 Dimensions F _w × E _w × B _c	型号 Bearing number	外形尺寸 Dimensions F _w × E _w × B _c	型号 Bearing number	外形尺寸 Dimensions F _w × E _w × B _c
K 45X49X19		K 47X55X28		K 55X63X20		K 60X75X42		K 70X78X30		K 90X97X20	
K 45X50X17		K 48X54X19		K 55X63X25		K 60X68X30		K 70X80X30		K 90X98X27	
K 45X50X27		K 48X54X25		K 55X63X32		KK 60X68X34		K 70X78X46		K 90X98X30	
K 45X50X32 TN		K 50X55X13.5		KK 55X60X40		KK 62X70X40		K 72X80X20		K 95X102X20	
K 45X52X18		K 50X55X17		K 56X61X20		KK 63X70X21		K 73X79X20		K 95X102X30	
K 45X52X21 TN		K 50X55X20		K 58X63X17		K 64X70X16		K 75X81X20		KK 95X103X40	
K 45X53X20		K 50X55X30		K 58X64X19		K 65X70X20		K 75X81X30		K 100X107X21	
K 45X53X21		K 50X57X18		K 58X65X18		K 65X70X30		K 75X83X23		K 100X108X27	
K 45X53X22		K 50X58X20		KK 58X65X38		K 65X73X23		K 75X83X30		K 100X108X30	
K 45X53X28		K 50X58X25		K 60X65X20		K 65X73X30		KK 75X83X35		K 105X112X21	
K 45X59X18 TN		K 52X57X12		K 60X65X30		K 68X74X20		KK 75X83X40		K 105X113X30	
K 45X59X32		K 55X60X20		K 60X68X20		K68X74X30		K 80X86X20		K 110X117X24	
KK 45X59X36		K 55X60X27		K 60X68X23		KK 68X74X35		K 80X86X30		K 110X118X30	
K 45X51X36		K 55X60X30		K 60X68X25		KK 68X75X20		K 80X88X30			
K 47X52X17		K 55X61X20		K 60X68X27		K 70X76X20		KK 80X88X40			
K 47X52X27		K 55X62X18		KK 60X66X33		K 70X76X30		KK 80X88X46			
K 47X53X25		K 55X63X15		KK 60X66X40		K 70X78X25		K 85X92X20			

<p>螺栓轴承/复合滚轮 Bolt bearing / composite roller</p>  <p>带密封和不带密封 Seal & no seal</p> <p>KR(PP) CRF(CRA) KRV(PP) 4.053...4.063 NUKR(PP) CR CF</p>	<p>支承轴承 带密封和不带密封 Yoke type track rollers Seal & no seal</p>  <p>NATR(PP) NATV(PP) NUTR STO RSTO NA22(2RS) RNA22(RS)</p>
<p>实体套圈滚针轴承不带内圈 带密封和不带密封 Needle roller bearings without inner ring (machined) Seal & no seal</p>  <p>RNA48(RS) RNA49(RS) RNA69 NK NKS BR(NCS) RNAO</p>	<p>组合轴承 Combined bearing</p>  <p>NKX NKX..Z NKXR ZARN ZARF NKIA NKIB</p>
<p>推力滚针保持架组件 带垫片和不带垫片 Axial needle roller cages Washers</p>  <p>AXK TRA NTA TRB AXW TRC AX TRD AS</p>	<p>推力圆柱滚子轴承 带垫片和不带垫片 Axial cylindrical roller bearings Washers</p>  <p>K811 K812 K874 K893 K894</p>
<p>冲压外圈滚针轴承 带密封和不带密封 Drawn cup needle bearings Seal & no seal</p>  <p>HK(2RS) BK(RS) SCE(BA) SCH(BHA)</p>	<p>冲压外圈滚针离合器 Drawn cup needle clutches</p>  <p>HF HFL HFZ(RC) HFLZ(RCB)</p>
<p>滚针保持架组件 Needle roller cage assemblies</p>  <p>K KK KZK KBK</p>	<p>非标轴承 Non-standard bearings</p> 



我们为所有工业提供优质的产品
We supply quality products to all industries

嘉兴伯恩利精密机械有限公司

地址：浙江省嘉善县陶庄镇夏湖大道 333 号 2 幢

邮箱：jsxy3@163.com

网站：www.burnley.com.cn

电话：13736870198

Jiaxing Burnley Precision Machinery Co.,Ltd

Add: NO.333, Building 2, 333 Xiahu Avenue, Taozhuang
Town, Jiashan County, Zhejiang Province, China.

E-mail: jsxy3@163.com

Web: www.burnley.com.cn

Tel: 13736870198